

**GENERAL PREFABBRICATI S.r.l.**

**Settore: PREFABBRICAZIONE**

**Componente: Canaletta tipo 46x70x2.00 C.E.**

Materiali da imp.:

Cls. RcK 450 kg/cm<sup>2</sup>

rete elet.  $\varnothing$  8 20x15

peso Kg. 835

### assonometria

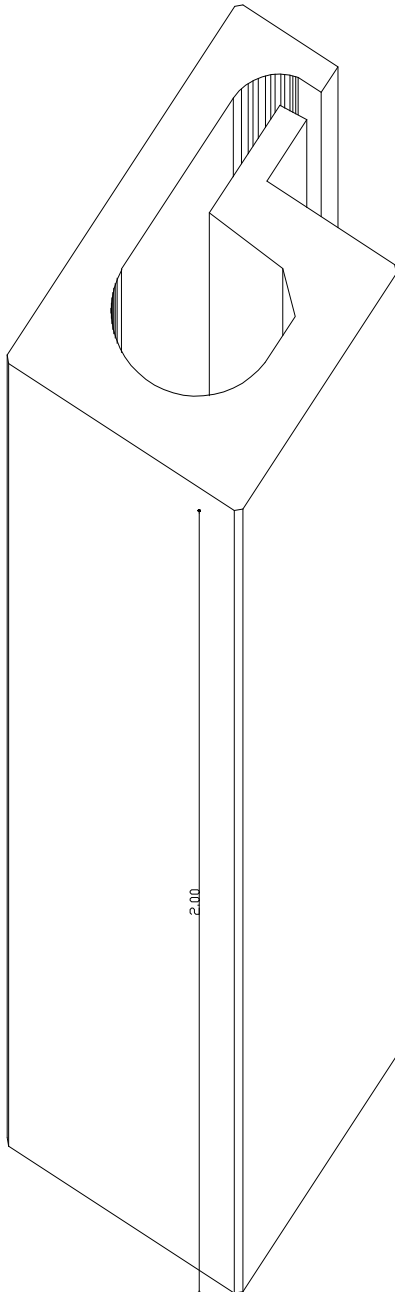

### sezione

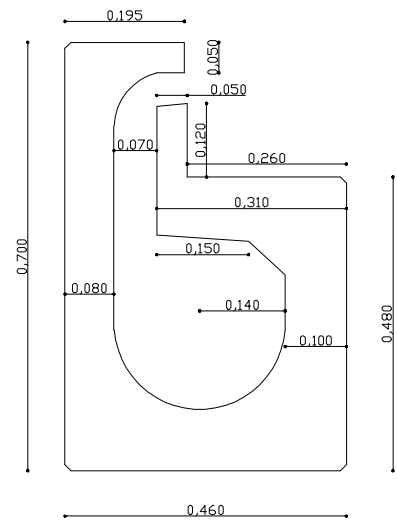

### armatura

