



GENERAL PREFABBRICATI SRL

Legale Rappresentante: Perretta Antonino - Cellulare: 339.3154808

Sede Legale: C.da Maitano snc - 85030 San Paolo Albanese (PZ)

Sede Operativa: C.da Maitano snc - 85030 San Paolo Albanese (PZ)

C.F. e P.IVA: 01919570760 - Iscrizione C.C.I.A.A. n° 144155

Telefono: 0973.644082 - Fax: 0973.644377

E.mail: generalprefabbricati@gmail.com

Pec: generalprefabbricati@pec.it

BROCHURE

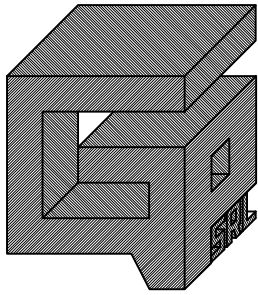

Oggetto: CUNETTA
 dim.. 0,42xH 0,60 xL 3,00 spes. 7/9 cm

Commissione:
 OLIVIERI COSTRUTTORI. Srl

Data:
 05-01-2016

ALL. 09/10
 REV. 0

Redatto da: geom.
 Walter Lambardella

Approvato da:
 Perretta Antonino

Sigla:
 C42_60

Quantita':

Volume
 calcestruz.:
 mc 0.44

Peso:
 q.li 11,00

telaio affogato nel calcestruzzo

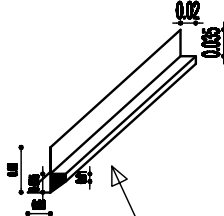

VISTA FRONTALE

PARTICOLARE INCASTRO

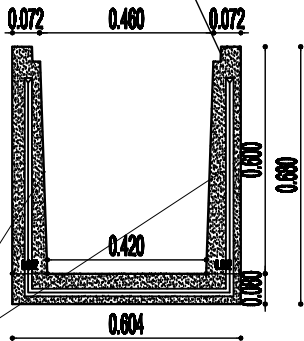
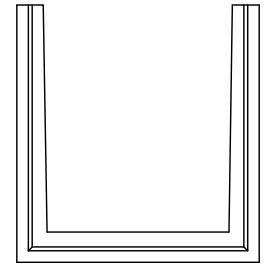
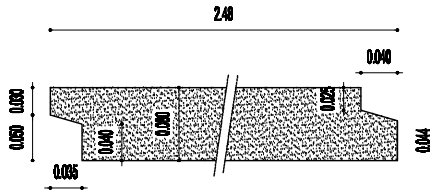

FORI DA 25 MM PER IL SOLLEVAMENTO

VISTA ASSONOMETRICA

ARMATURA

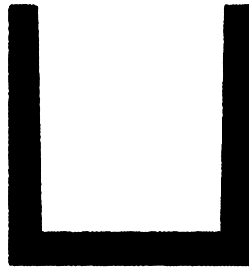

RETE ELETTRISALDATA FILO 5 MAGLIA 10X10

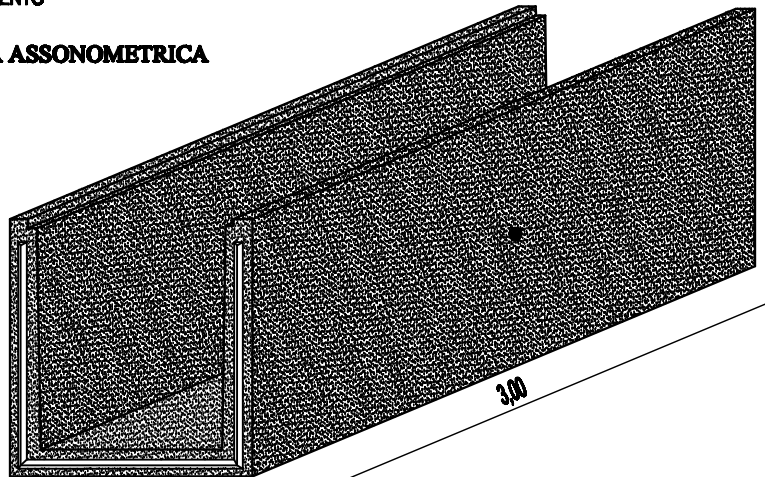

Dimensione:	Progetto:	Reale:	Differenza:	Si:	No:	Classe di resistenza cla. a 28 gg.: $R_{ck} \geq 35 \text{ N/mm}^2$ (C28/35) Classe di resistenza cla. allo scasso: $R_{ck} \geq 20 \text{ N/mm}^2$ (C16/20) Classe di esposizione EN 206-1: XCS ACCIAIO: B480C	Classe di consistenza: S4 Rapporto A/C: = 0,51 Aggregato ϕ max: 21 mm
Larghezza (cm)	3,00						
Altezza (cm)	0,60						
Spessore (cm)	7/9						
						REI: Copriferro: distanziatore altezza mm 35	Tolleranze di produzione (UNI EN 13369:2008). Definizione di tolleranza: δ definita come la differenza tra le due dimensioni limite, minima e massima (δ_{AL}), in riferimento a quella assegnata al manufatto: Lunghezza/larghezza fino a mm 1000 $\pm \Delta L = 10 \text{ mm}$ Lunghezza/larghezza oltre mm 1000 $\pm \Delta L = 9 + L/1000 \text{ (mm)}$ Spessori "t" e misure corte (fino a mm 1.000) $\pm \Delta h = 10 \text{ mm}$ Rettifinita "r" in qualsiasi piano principale: $\pm \mu = L/700 \text{ (mm)}$ Squadratura "v" e misure angolari: $\pm \delta = 1/1000 \text{ (mm)}$

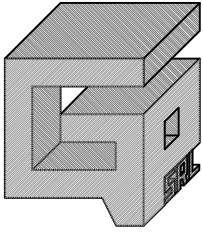

GENERAL PREFABBRICATI S.r.l.

Settore: PREFABBRICAZIONE

Componente: Canaletta tipo 46x70x2.00 C.E.

Materiali da imp.:

Cls. RcK 450 kg/cm²

rete elet. \varnothing 8 20x15

peso Kg. 835

assonometria

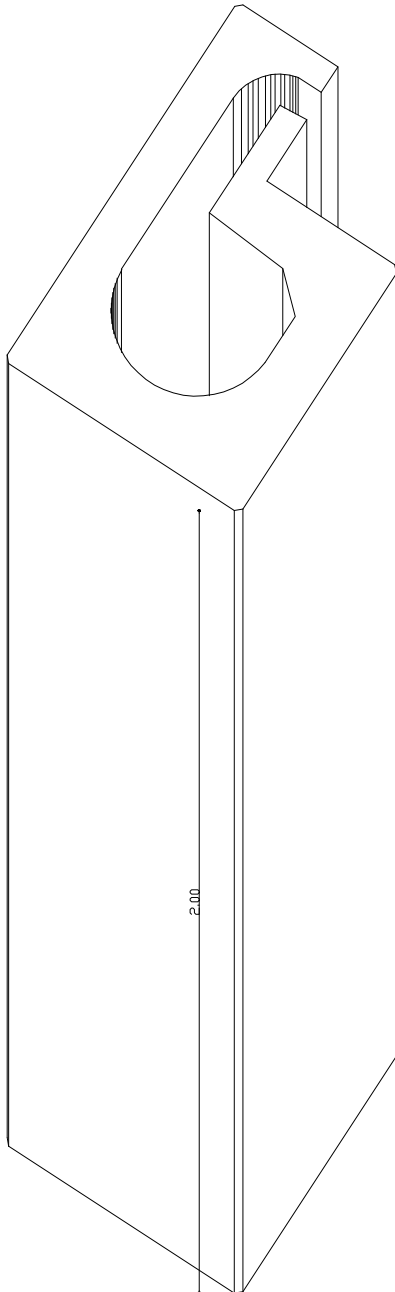

sezione

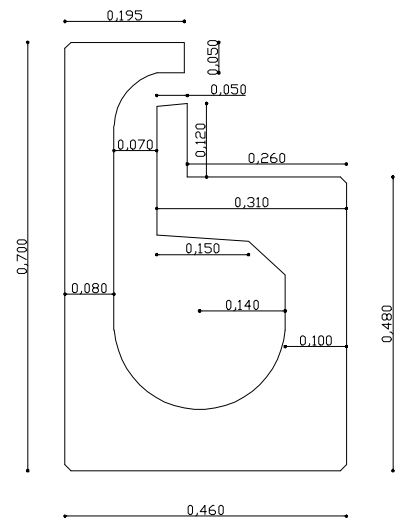

armatura

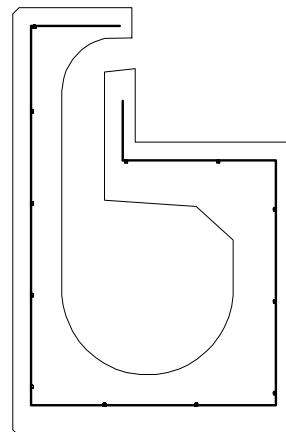

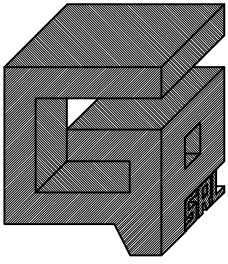

GENERAL PREFABBRICATI S.r.l.

Settore: PREFABBRICAZIONE

Componente: Canaletta tipo 52 x 49 lung. 155

Materiali da imp.:

Cls. RcK 450 kg/cmq

acciaio B450C

peso Kg/ml 620 circa

assonometria

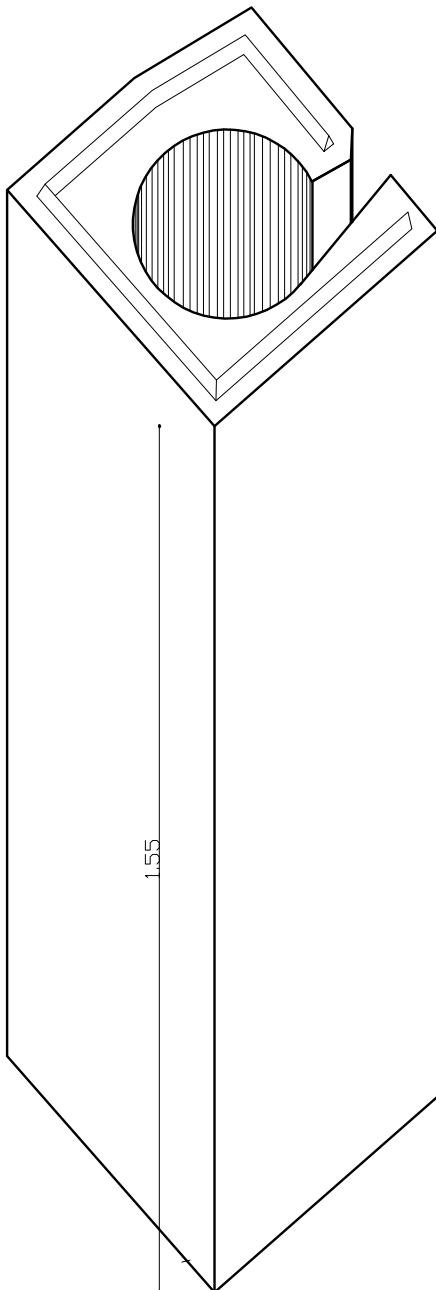

Particolare incastro

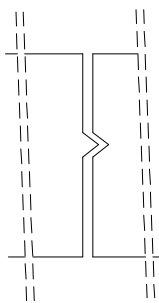

Pianta

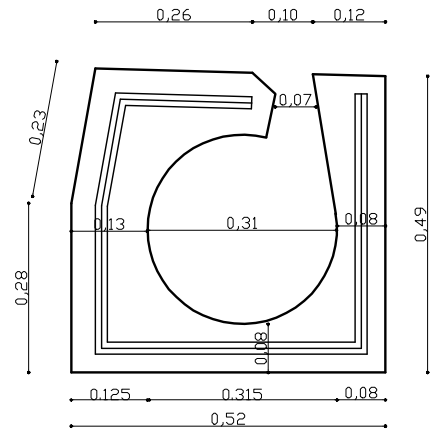

**armatura con rete elettrosaldata
pos. 1**

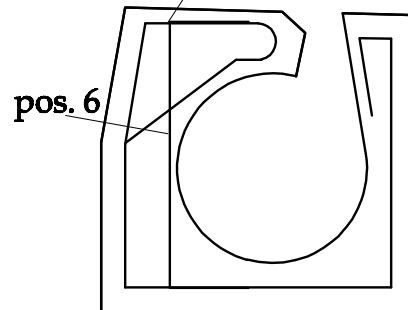

rete elettrosaldata filo 10 15x15

pos. 1

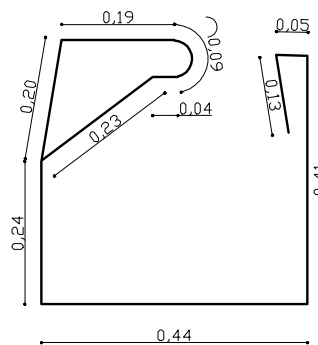

pos. 6

1 Ø 10/20 cm

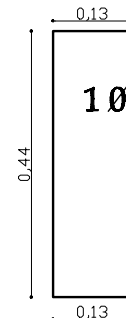

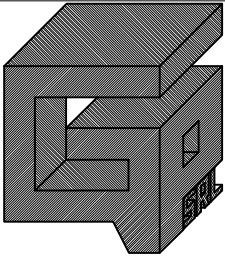

GENERAL PREFABBRICATI S.r.l.

Settore: PREFABBRICAZIONE

Componente: CANALETTA 70 X 242

Materiali da imp.:

Cls. RcK 350 kg/cmq

Acciaio B450C

Peso circa 800 kg

mc 0.139

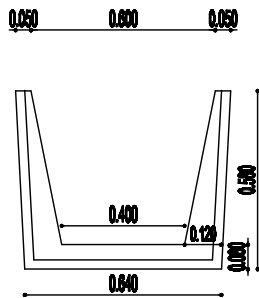

Prospetto

Armatura

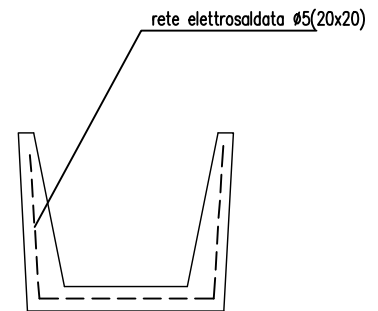

Vista assonometrica

fori per sollevamento

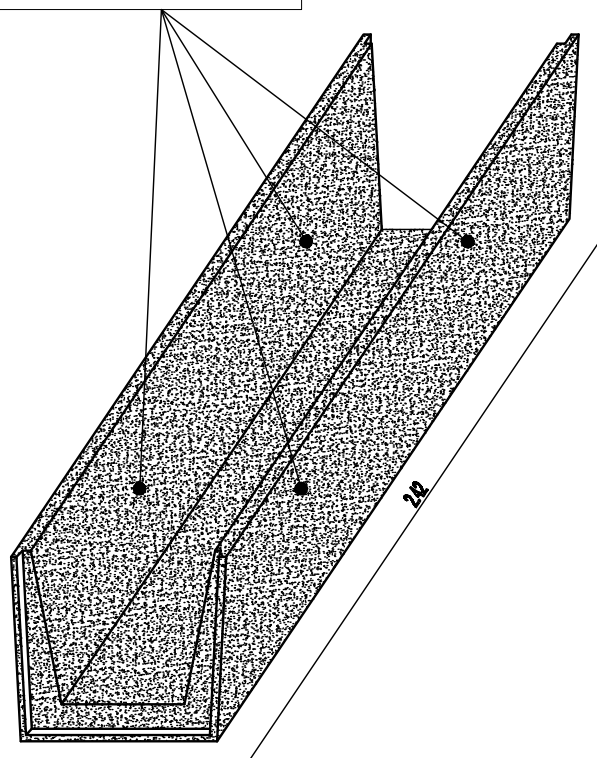

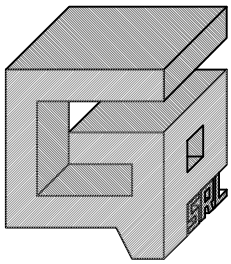

GENERAL PREFABBRICATI S.r.l.

Settore: PREFABBRICAZIONE

Componente: CANALETTE

CANALETTA ALLA FRANCESE ARMATA

Materiali da imp.:

Cls. RcK 350 kg/cmq

Acciaio B450C

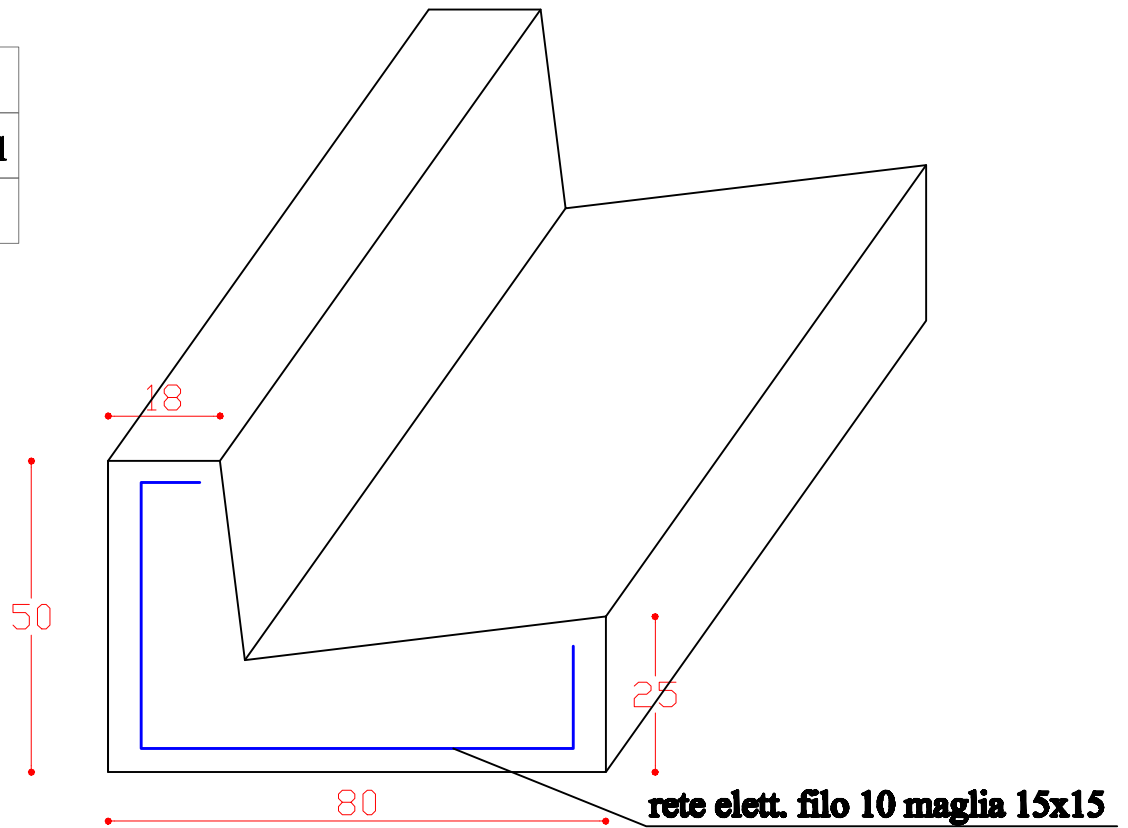

Materiali da imp.:

Cls. RcK 350 kg/cmq

Acciaio B450C

CANALETTA (TC)

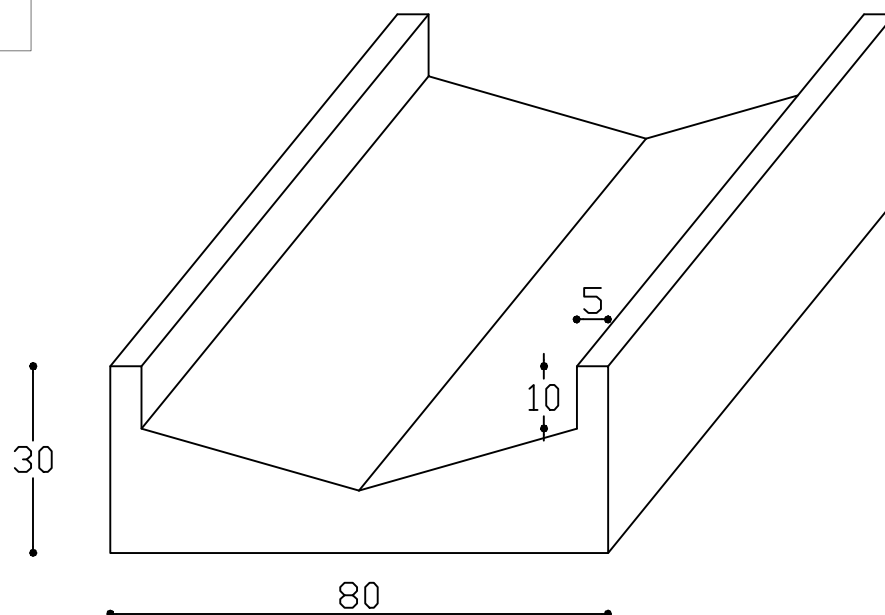

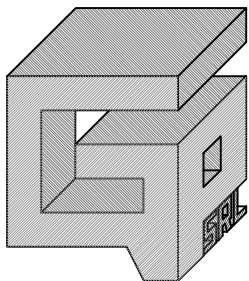

GENERAL PREFABBRICATI S.r.l.

Settore: PREFABBRICAZIONE

Componente: COPPELLA

Pianta Coppella

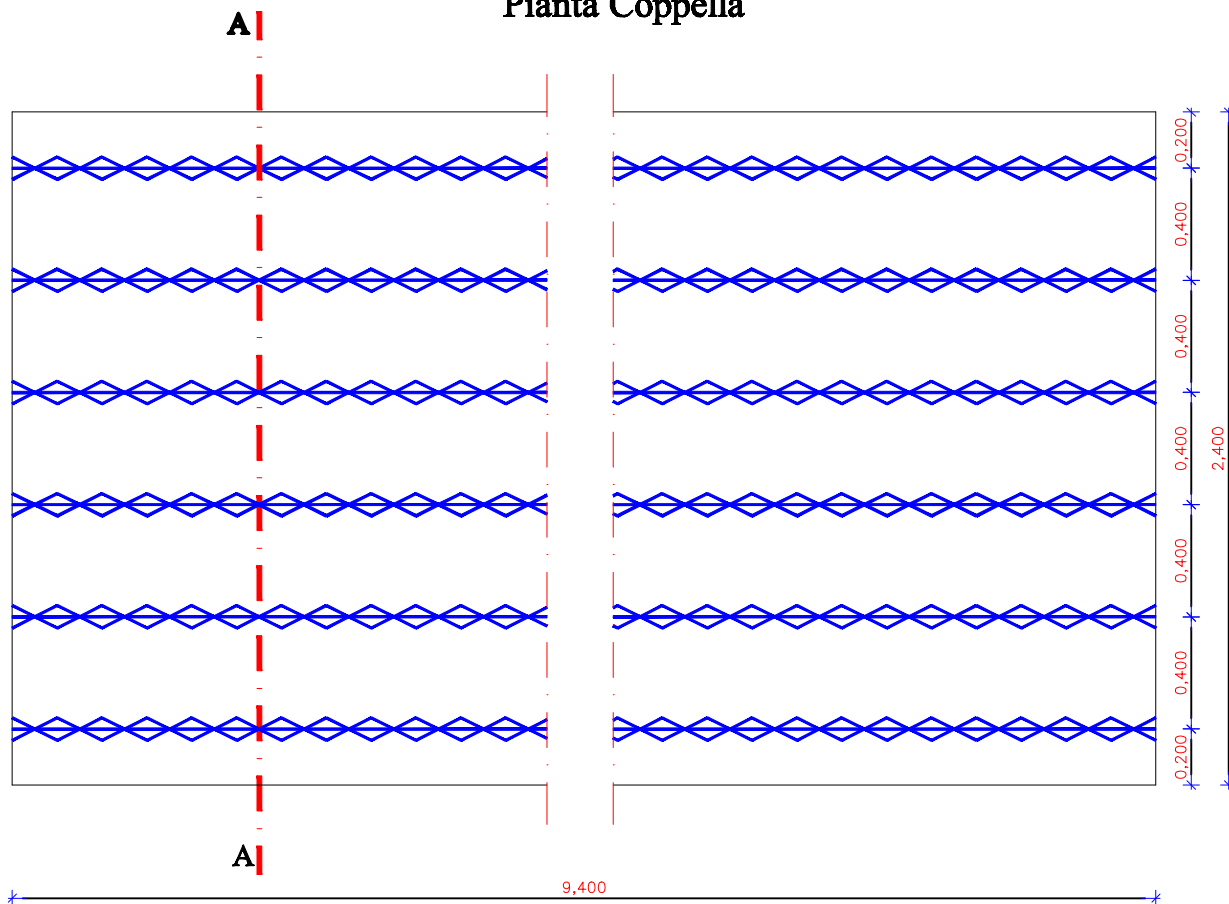

Sezione A-A

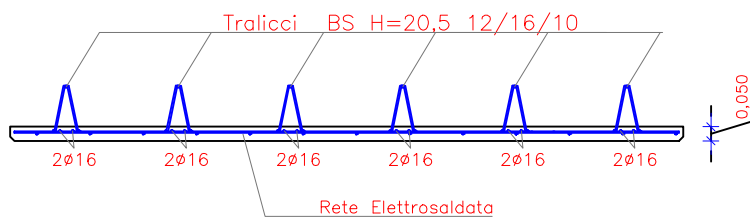

SCHEMA TECNICA

cls Rck 350
acciaio FeB44k
rete elettrosaldata $\phi 5/19 \times 25$
traliccio BS H=20.5 12/16/10

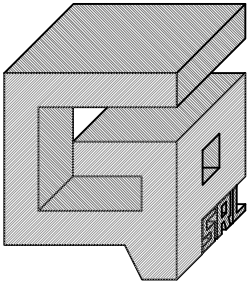

GENERAL PREFABBRICATI S.r.l.

Settore: PREFABBRICAZIONE

Componente: Copri Muro tipo A

MATERIALE:

**Calcestruzzo Rck 350A
acciaio B450C**

VISTA ASSONOMETRICA

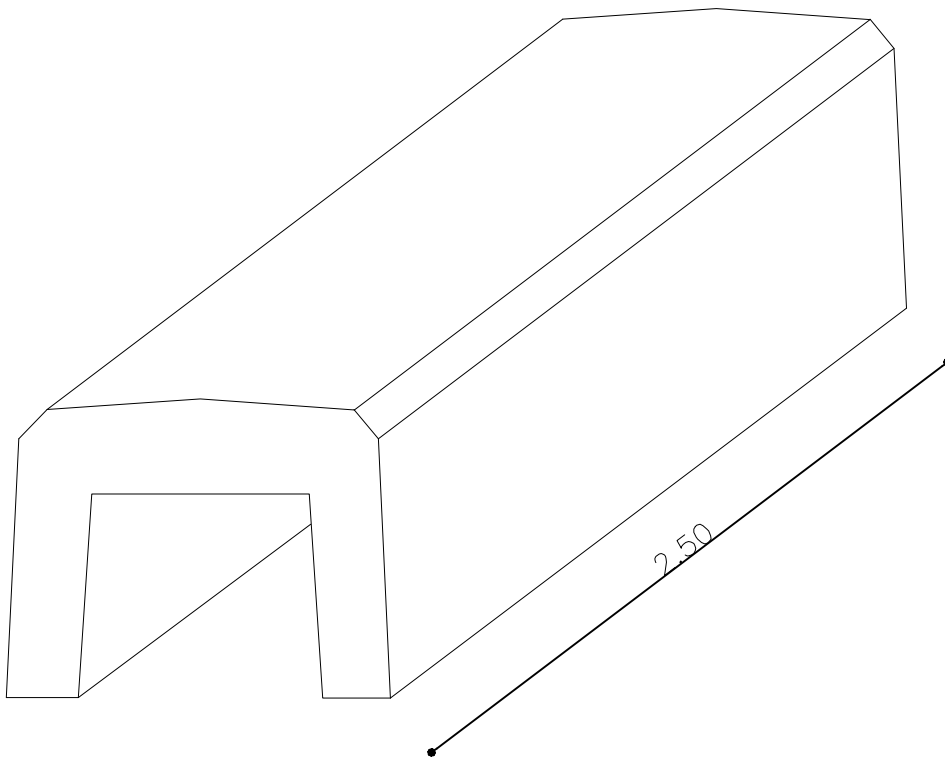

SEZIONI ORIZZONTALI

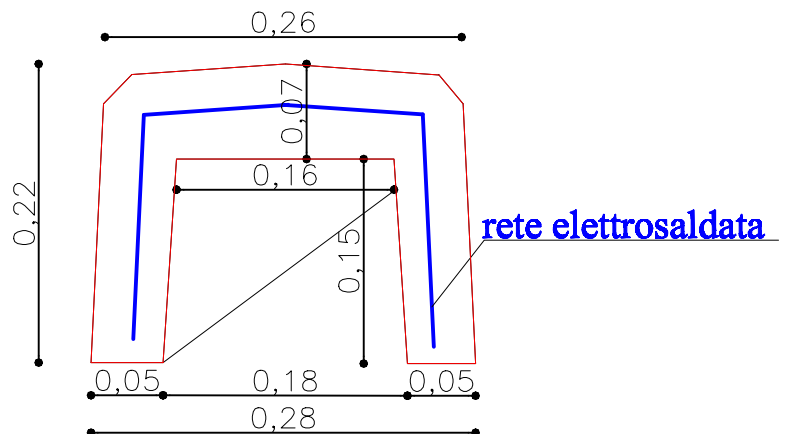

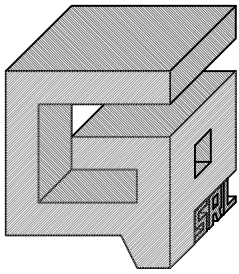

GENERAL PREFABBRICATI S.r.l.

Settore: PREFABBRICAZIONE

Componente: CORDOLO

Vista in Prospetto

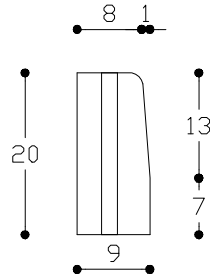

Vista Assonometrica

Particolare incastro tra elementi

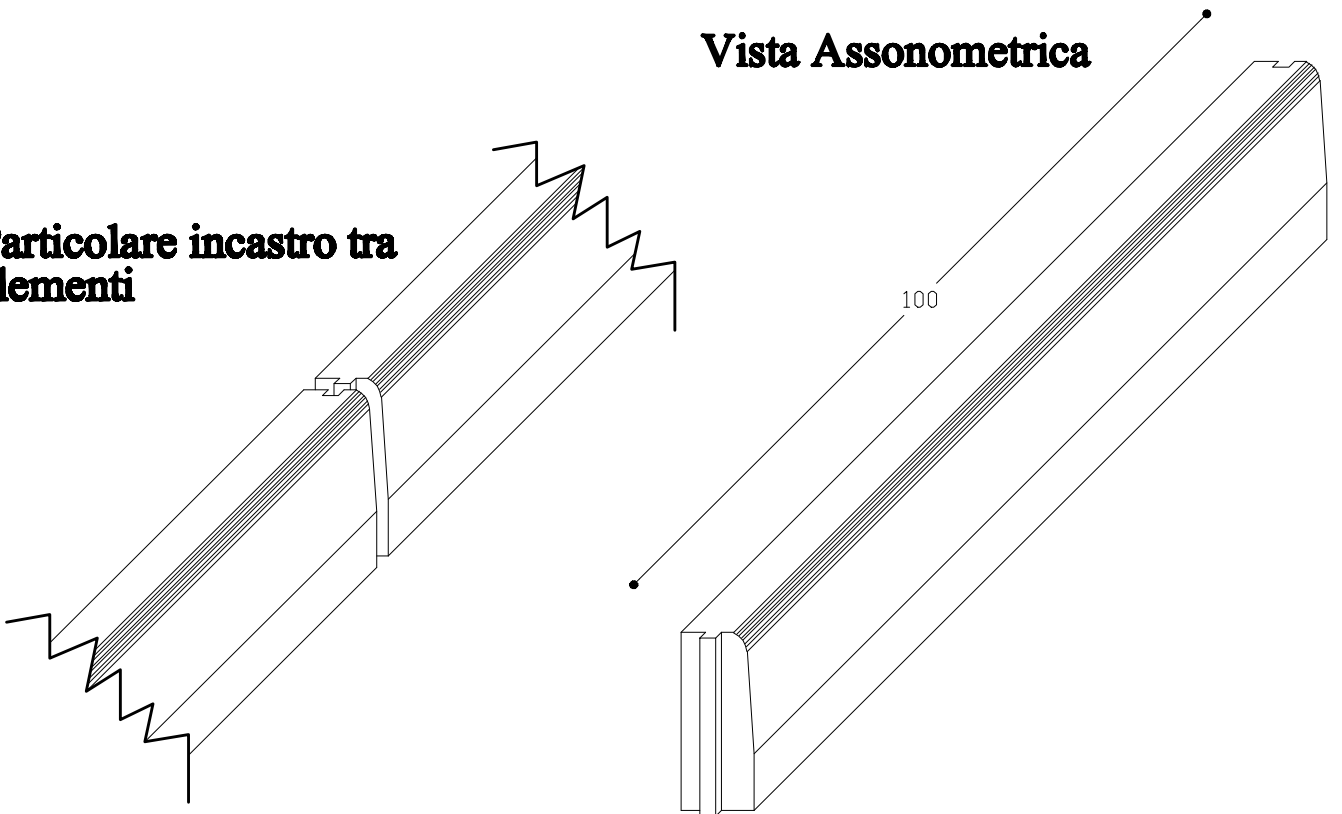

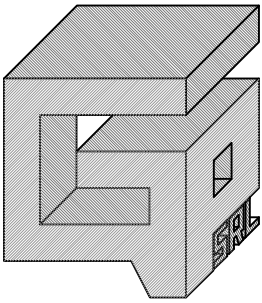

GENERAL PREFABBRICATI S.r.l.

Settore: PREFABBRICAZIONE

Componente: CUNETTA tipo 1

Materiali da imp.:

Cls. RcK 350 kg/cmq

Acciaio B450C

peso Kg. 225 (circa)

Vista in Sezione

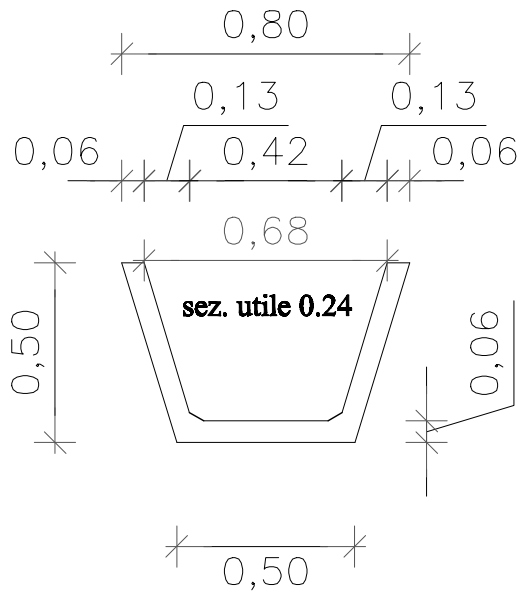

Vista Assonometrica

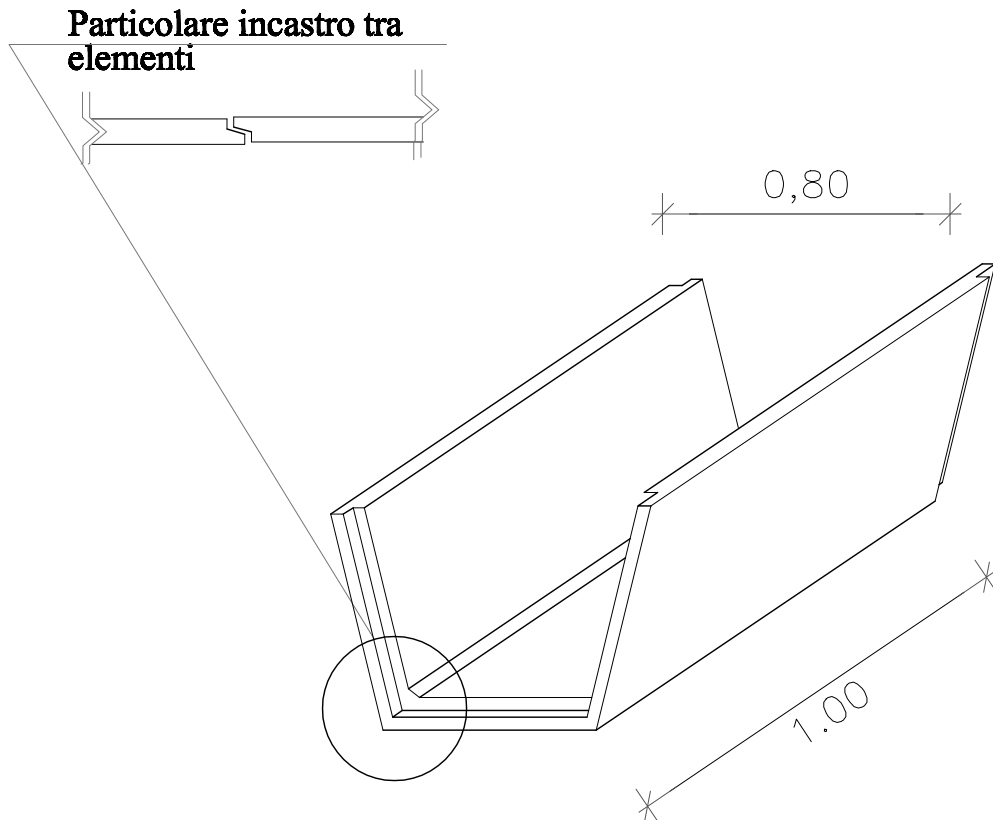

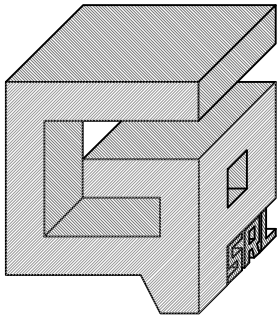

GENERAL PREFABBRICATI S.r.l.

Settore: PREFABBRICAZIONE

**Componente:
CUNETTA TIPO b28 X L100 X h24**

Vista in Sezione

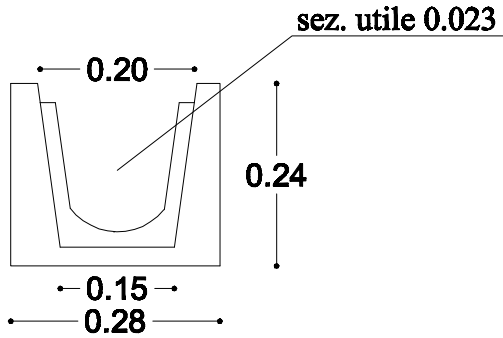

Vista Assonometrica

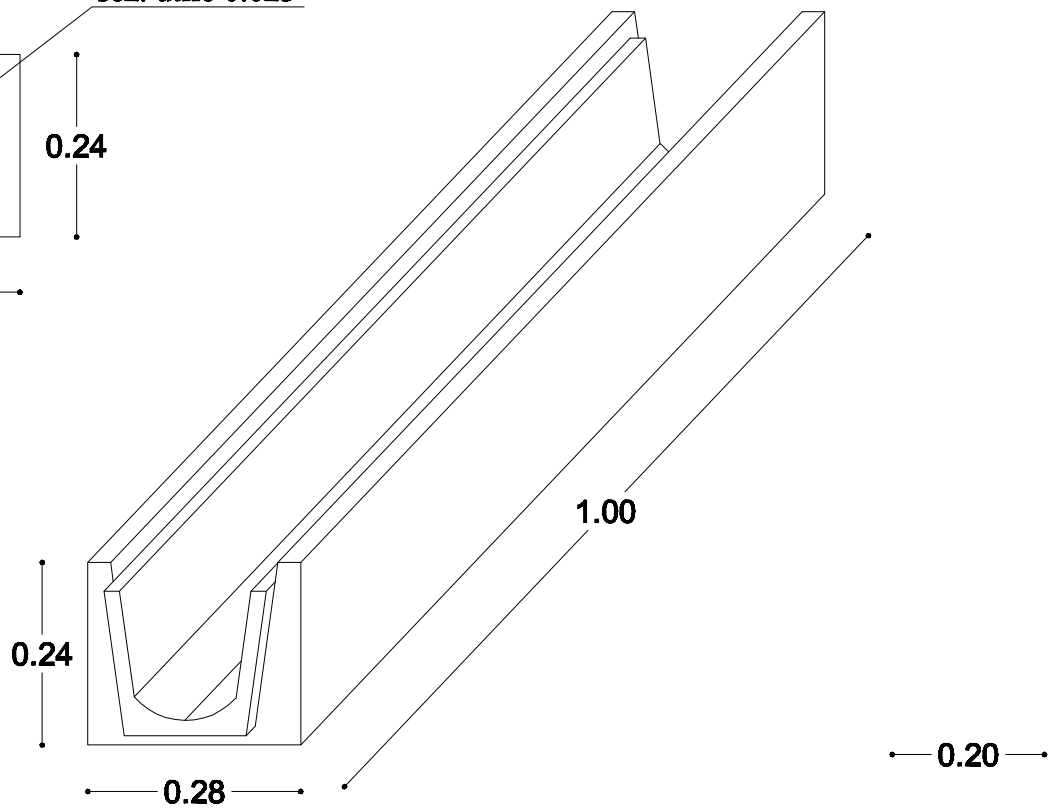

Griglia in ghisa

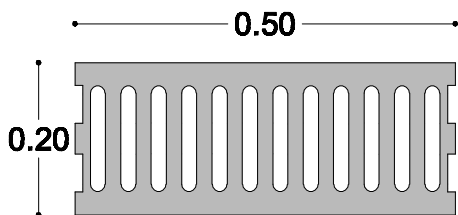

Griglia zincata

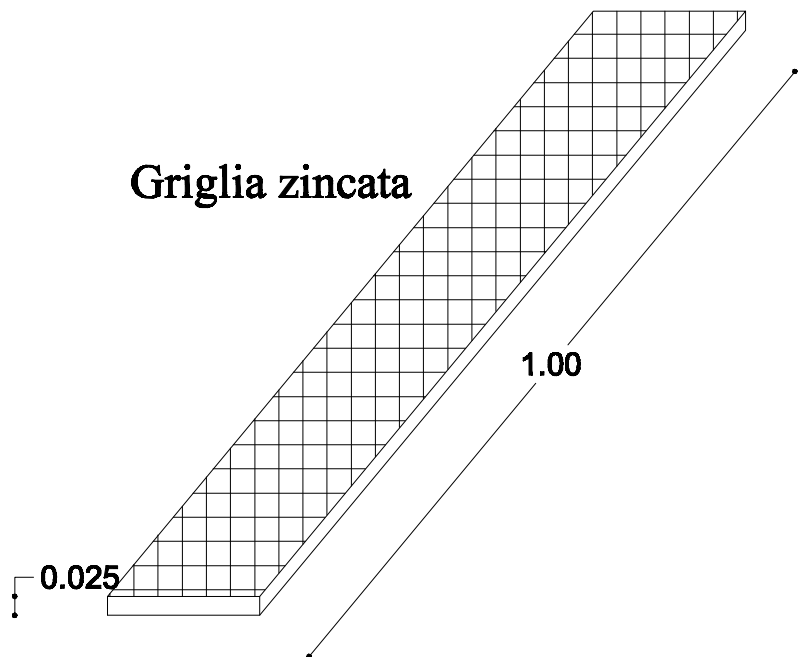

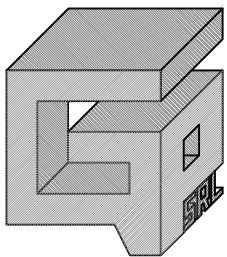

GENERAL PREFABBRICATI S.r.l.

Settore: PREFABBRICAZIONE

Componente: CUNETTA TIPO 45x40x200

Materiali da imp.:

Cls. RcK 350 kg/cmq

Acciaio B450C

peso Kg. 470 (circa)

Vista in Sezione

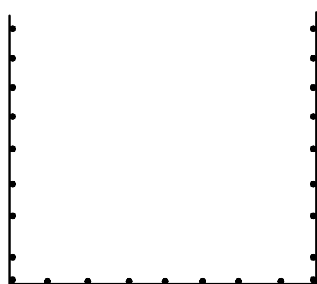

rete filo 5 maglia 10x10

Vista in Sezione

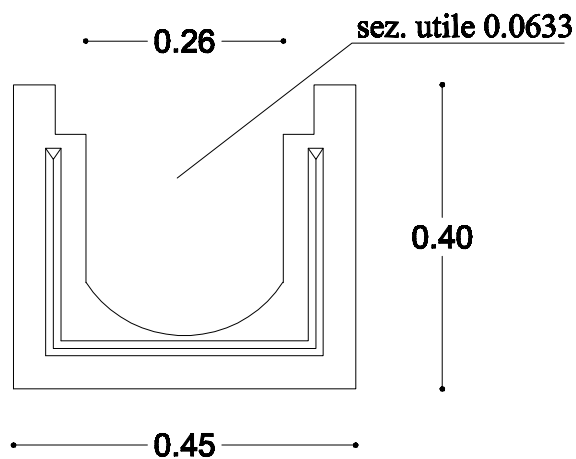

Vista Assonometrica

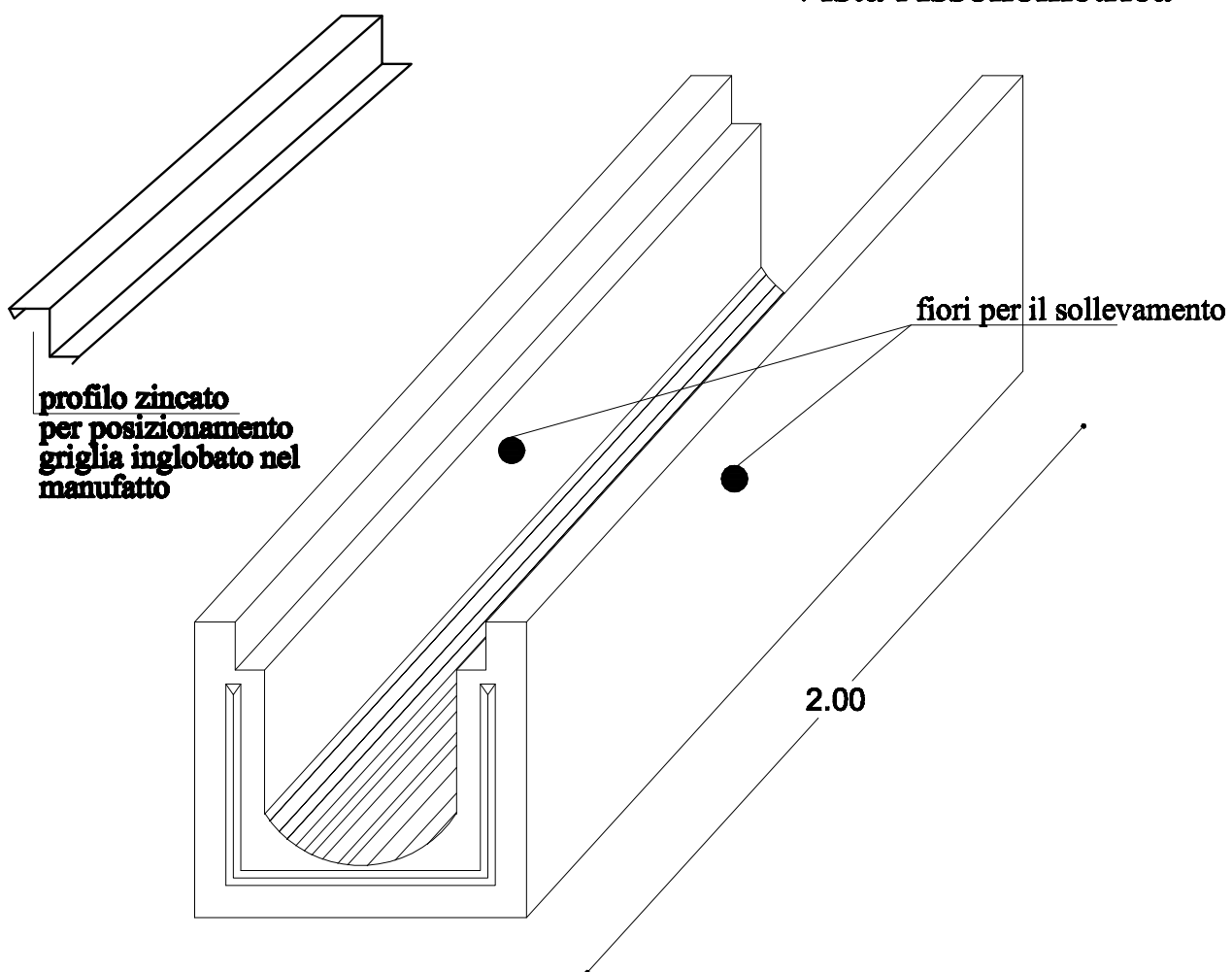

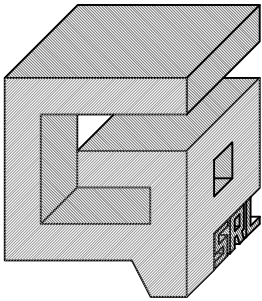

GENERAL PREFABBRICATI S.r.l.

Settore: PREFABBRICAZIONE

Componente: CUNETTA tipo 50x100

Materiali da imp.:

Cls. RcK 350 kg/cmq

Acciaio B450C

peso Kg. 225 (circa)

Vista in Sezione

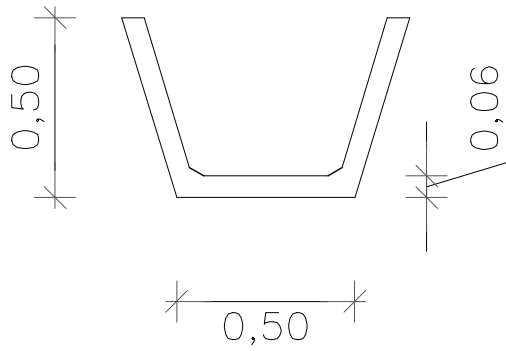
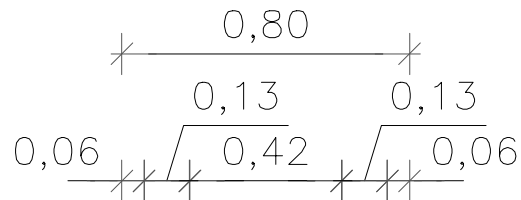

Dettaglio Armatura

rete ϕ 5 10x10

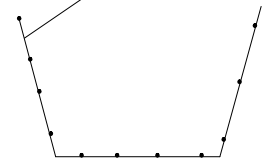

Vista Assonometrica

Particolare incastro tra elementi

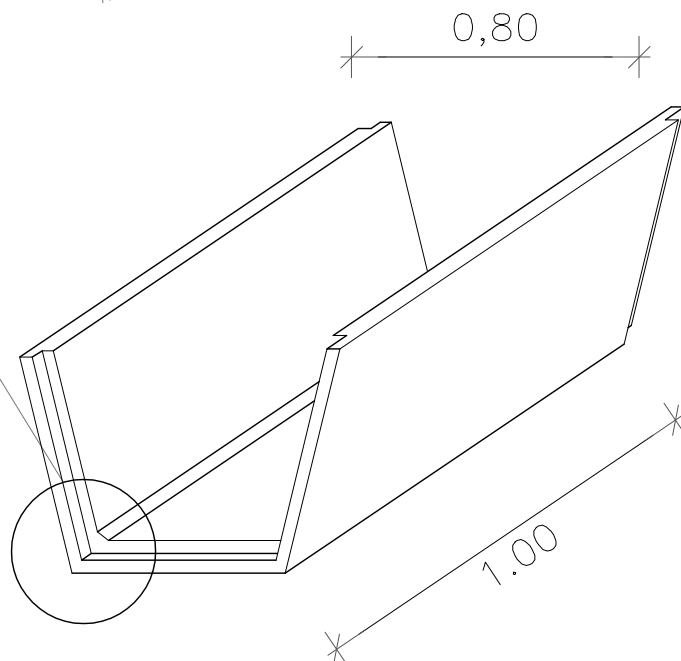
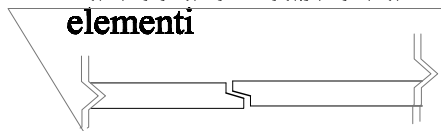

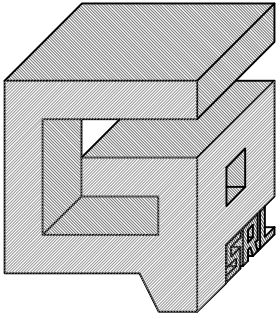

GENERAL PREFABBRICATI S.r.l.

Settore: PREFABBRICAZIONE

Componente: Copri Muro tipo A

MATERIALE:

VISTA ASSONOMETRICA

Calcestruzzo Rck 400

Acciaio B450C

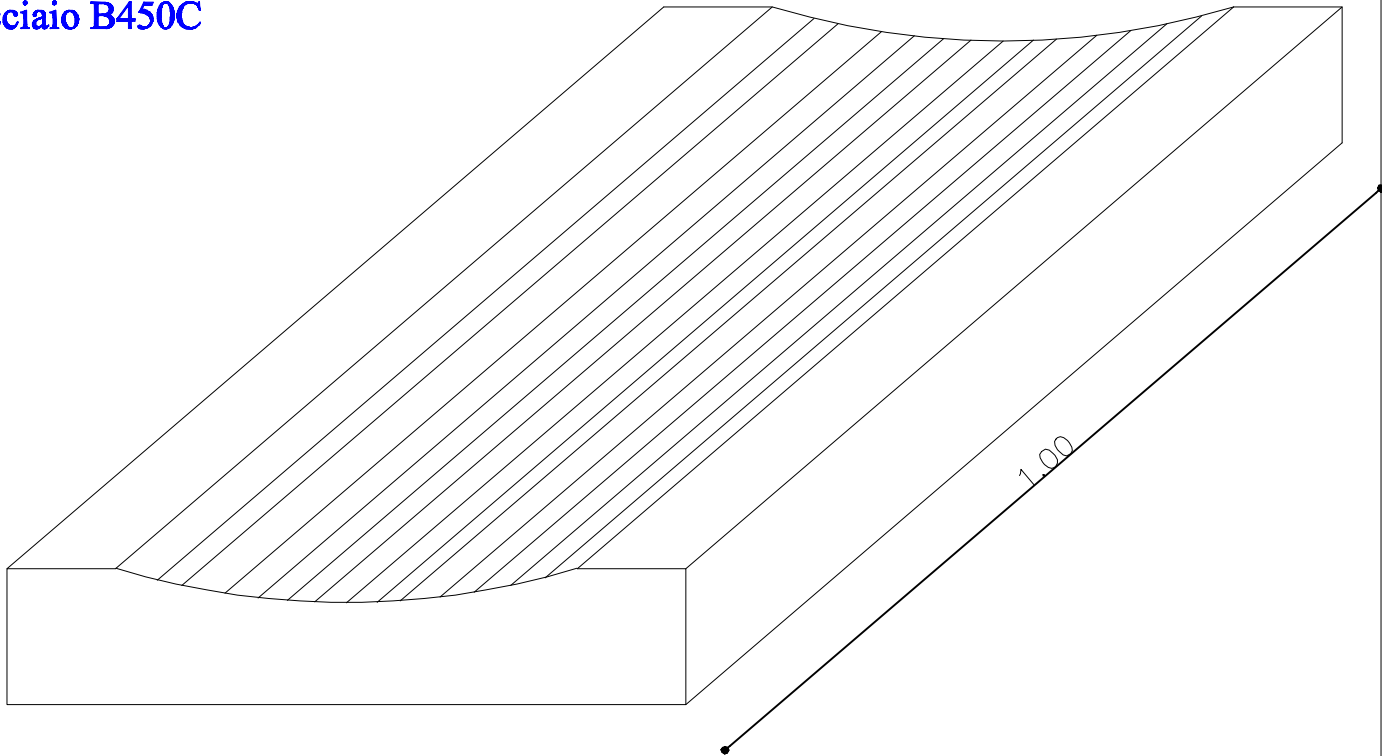

SEZIONI ORIZZONTALI

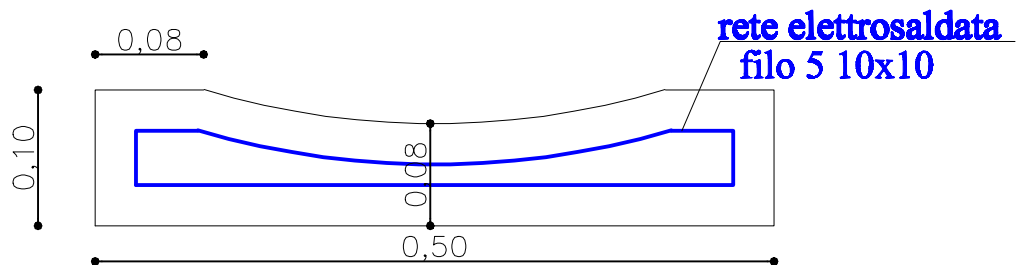

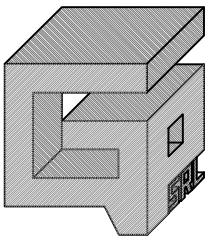

GENERAL PREFABBRICATI S.r.l.

Settore: PREFABBRICAZIONE

Componente: CUNETTA tipo 2

Calcestruzzo Rck 350

Acciaio B450C

Peso Manuf. kg 2700 c.a

Vista in Sezione

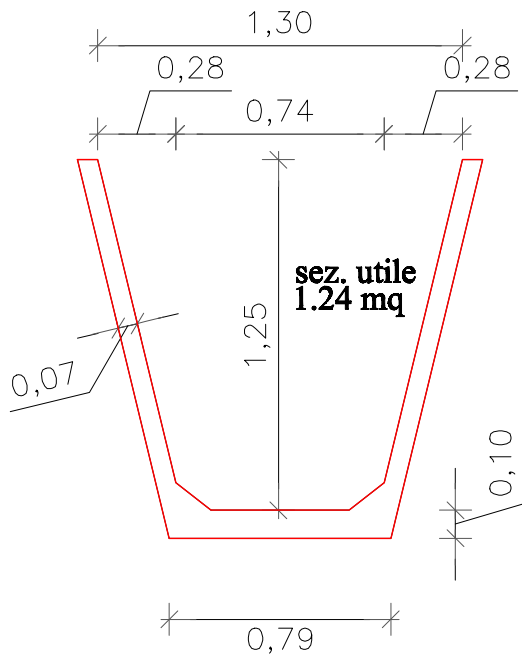

Rete ϕ 5 10x10

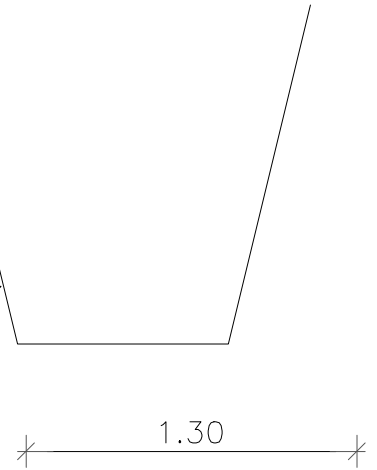

**Particolare incastro tra
elementi**

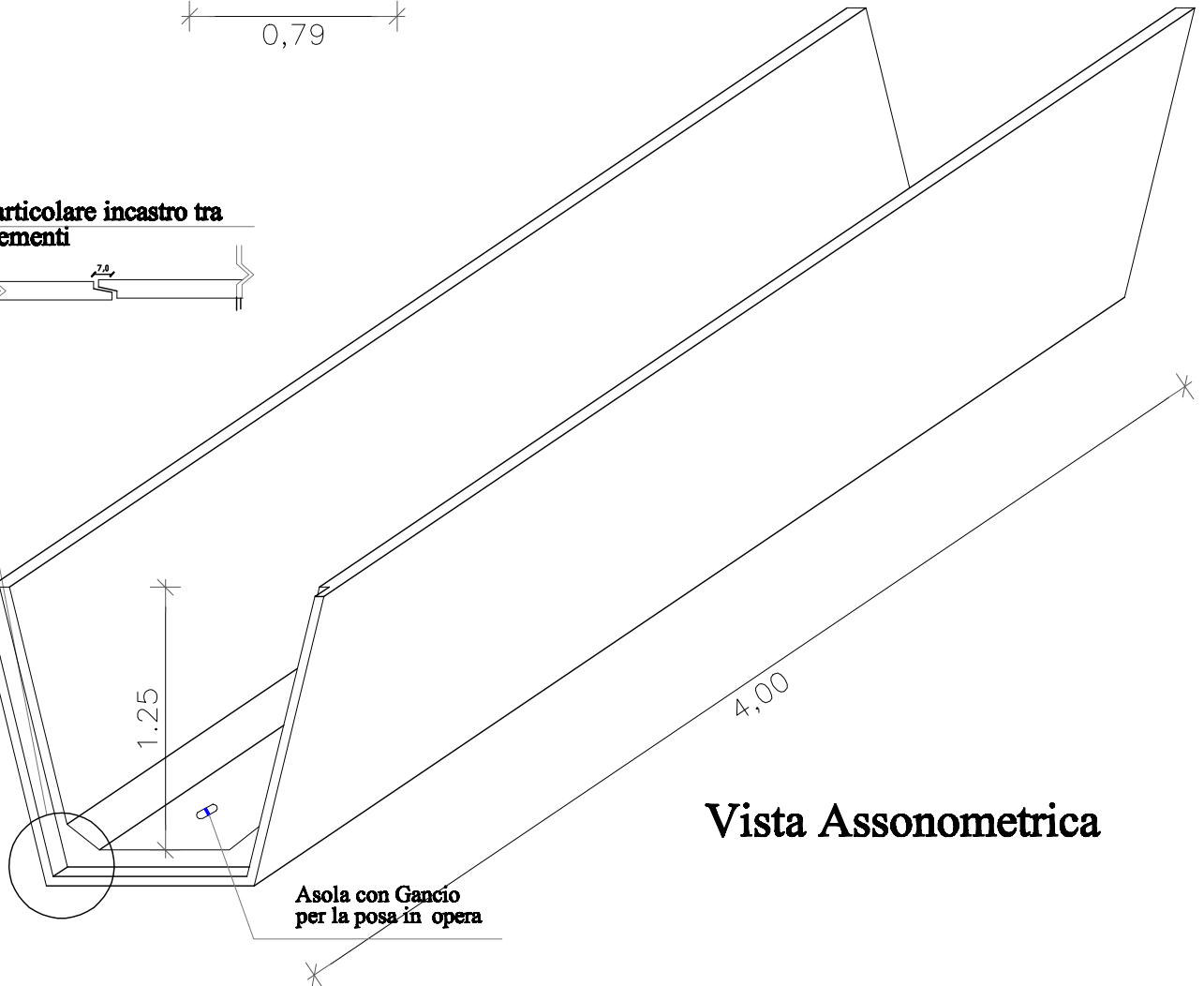
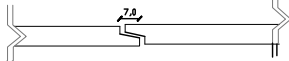

Vista Assonometrica

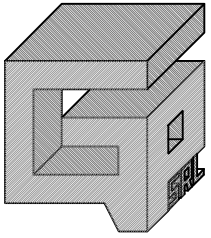

GENERAL PREFABBRICATI S.r.l.

Settore: PREFABBRICAZIONE

Componente: CUNETTA tipo 3

Vista in Sezione

Peso Manuf. kg 1985 c.a

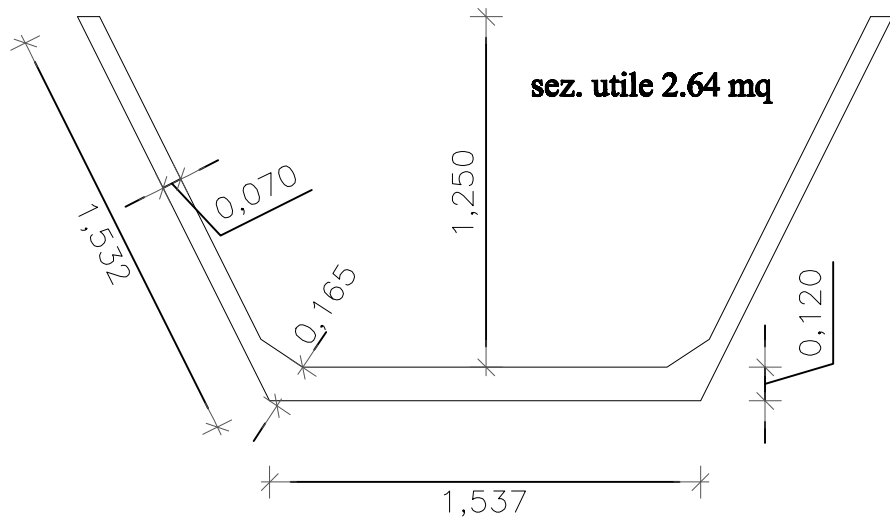
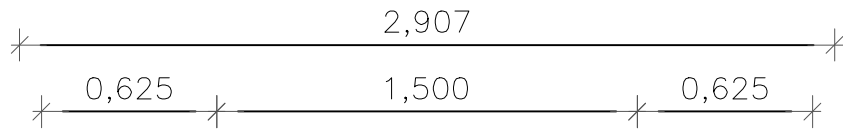

Particolare incastro tra elementi

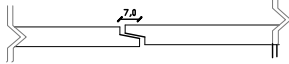

Vista Assonometrica

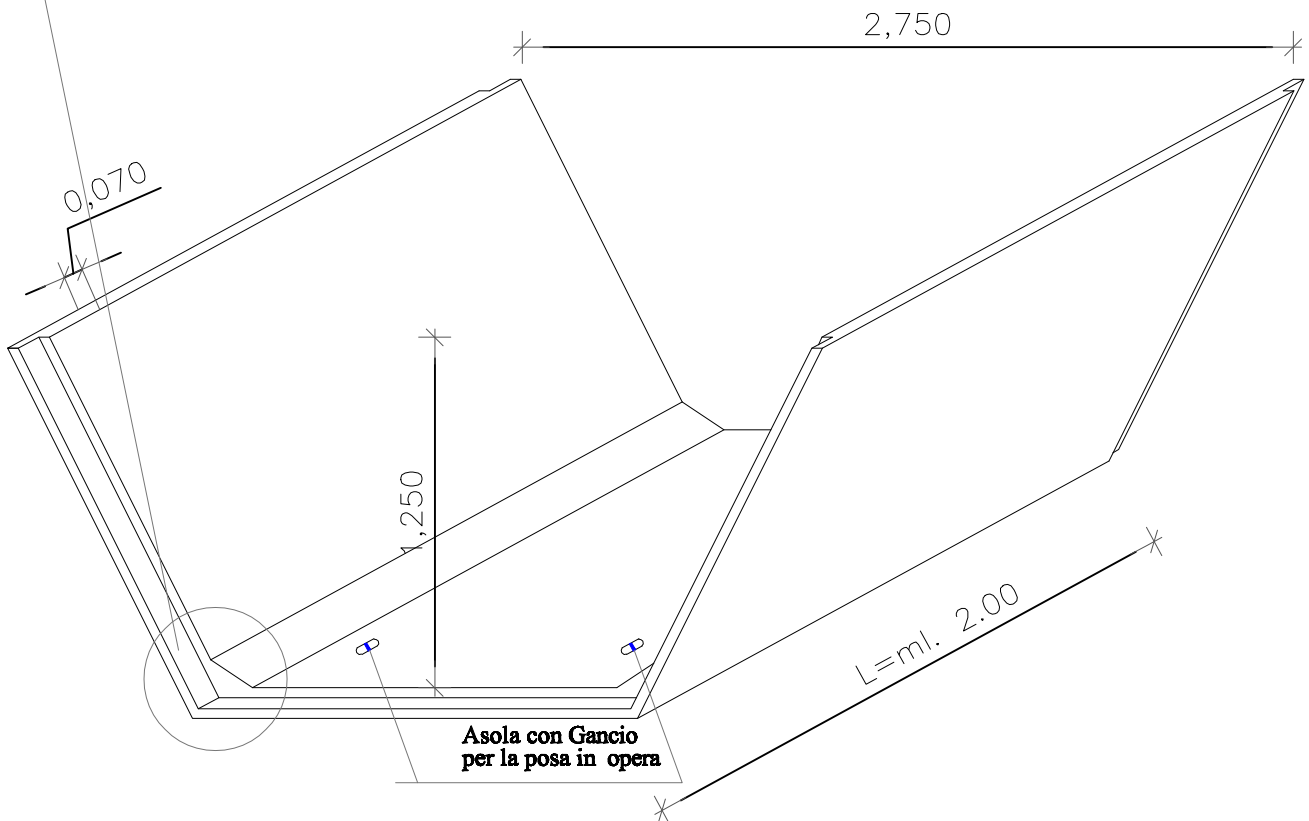

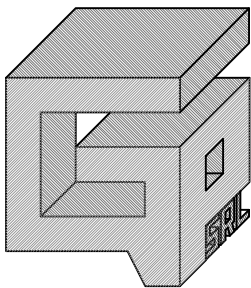

GENERAL PREFABBRICATI S.r.l.

Settore: PREFABBRICAZIONE

Componente: CUNETTA tipo 200xb0.50xl200

Vista in Sezione

Materiale da imp.:

Cls. Rck 300 Kg/cm²

Acciaio Feb44K

rete elet. ϕ 5 15x15

Peso Manuf. kg 1050 cir

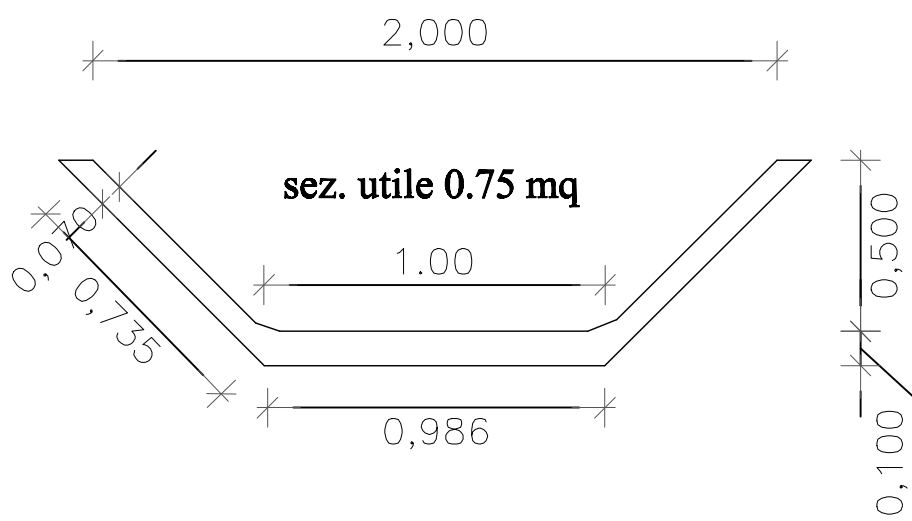

Particolare incastro tra elementi

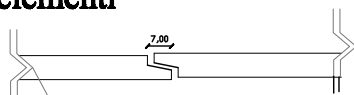

Vista Assonometrica

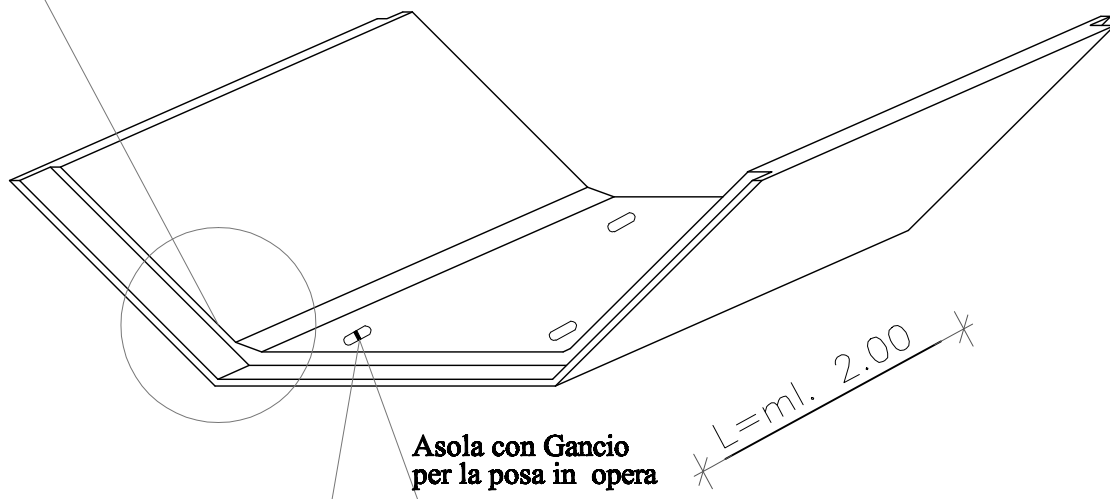

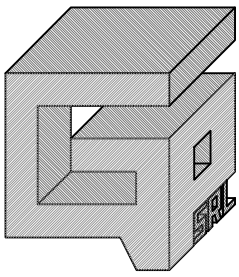

GENERAL PREFABBRICATI S.r.l.

Settore: **PREFABBRICAZIONE**

Componente: **CUNETTA tipo A**

Materiali da imp.:

Cls. RcK 350 kg/cm²

Acciaio B450C

peso Kg. 600 (circa)

Vista in Sezione

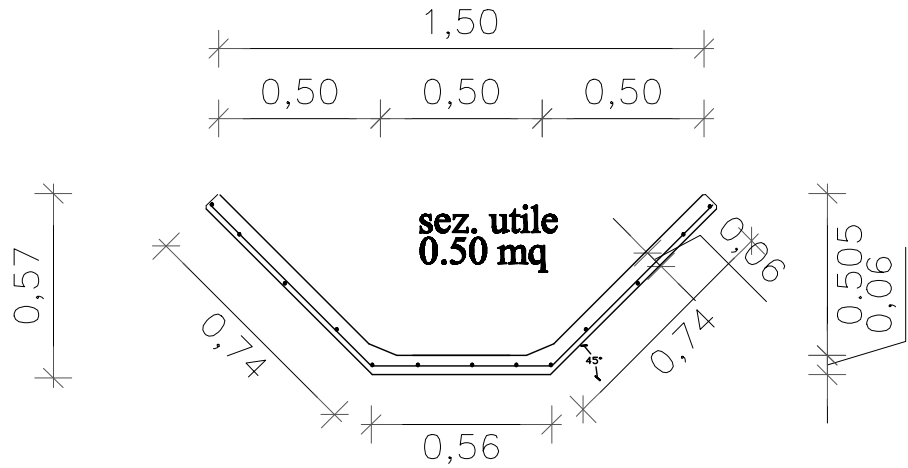

Dettaglio Armatura

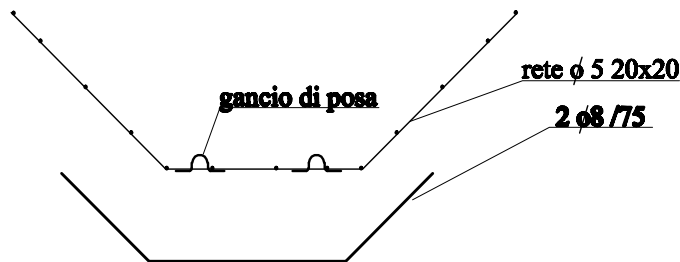

Vista Assonometrica

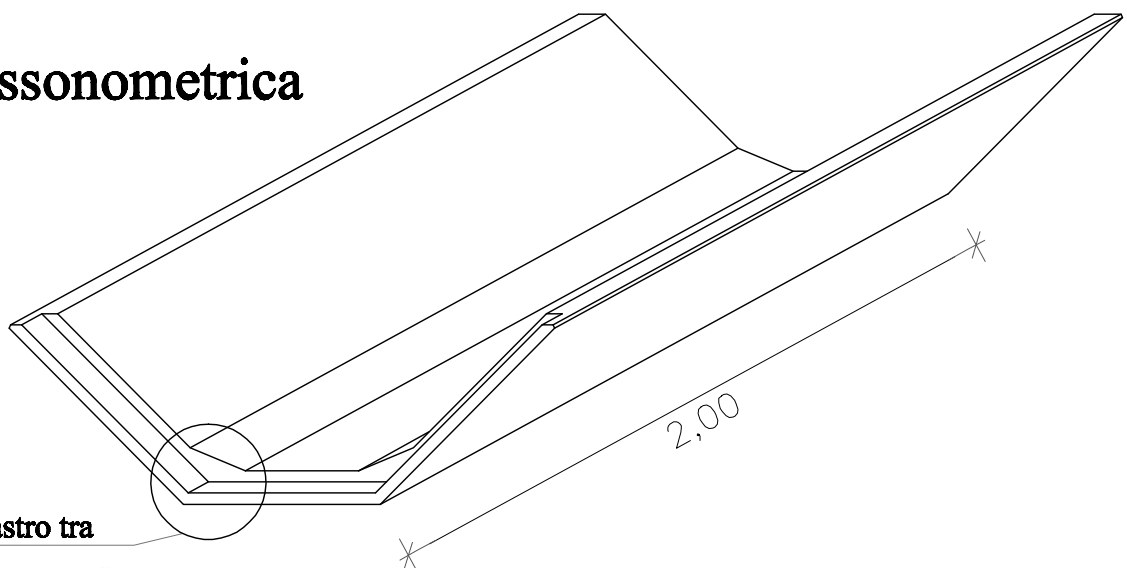

Particolare incastro tra elementi

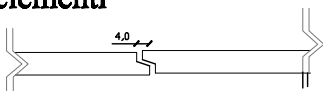

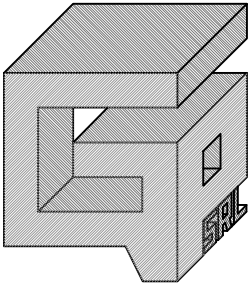

GENERAL PREFABBRICATI S.r.l.

Settore: PREFABBRICAZIONE

Componente: CUNETTA tipo B

Materiali da imp.:

Cls. RcK 300 kg/cmq

Acciaio Feb44K

peso Kg. 893 (circa)

Vista in Sezione

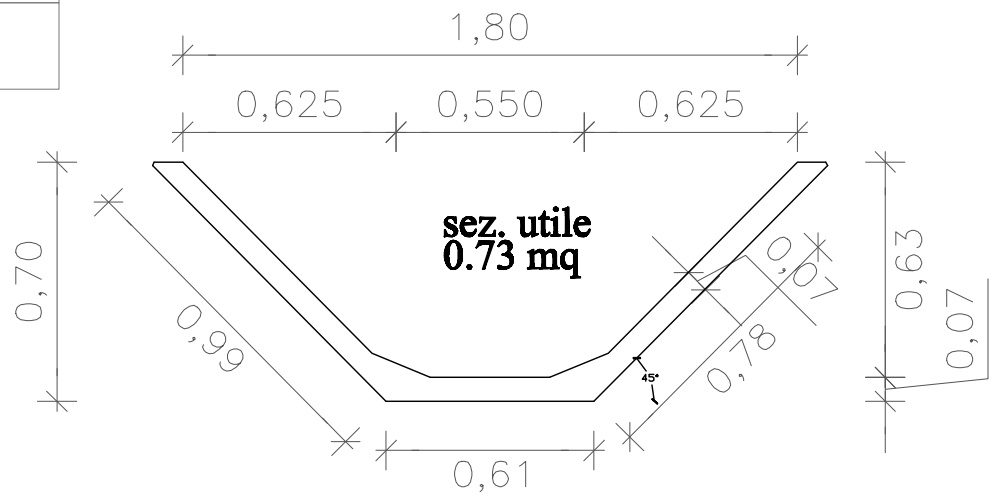

Vista Assonometrica

Particolare incastro tra elementi

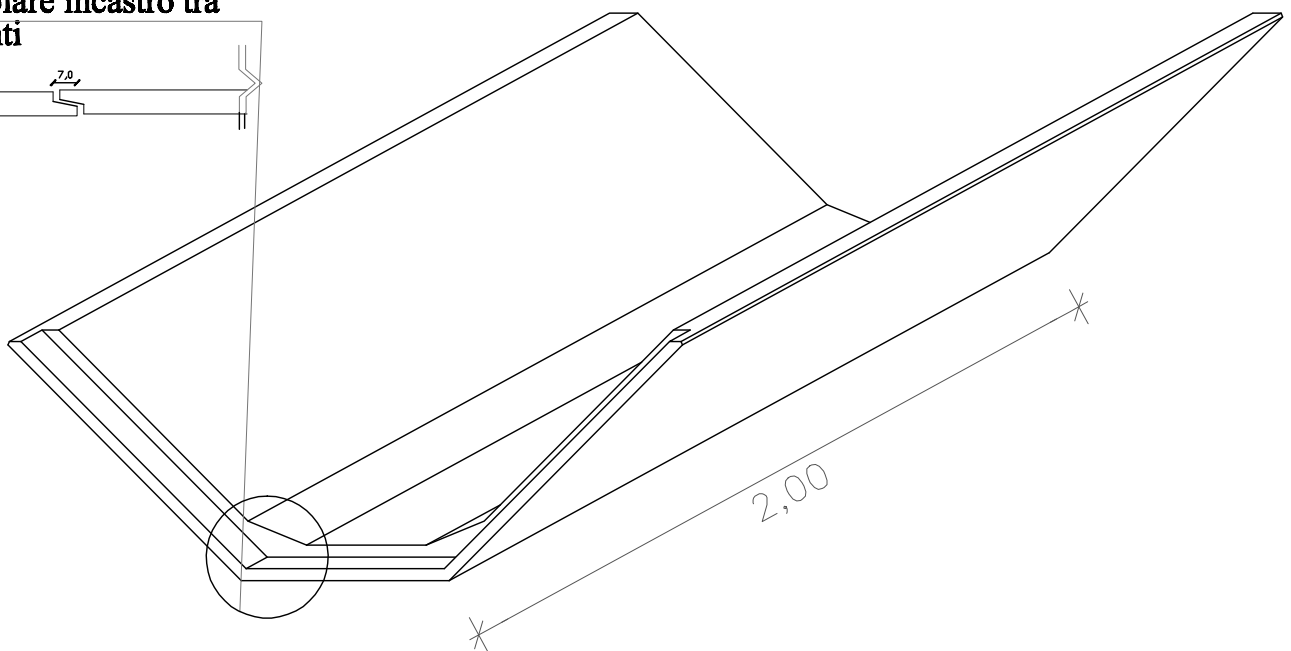
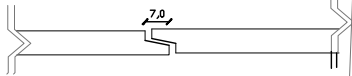

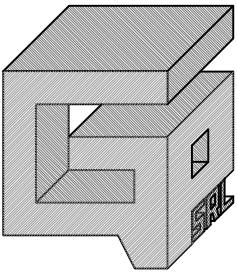

GENERAL PREFABBRICATI S.r.l.

Settore: PREFABBRICAZIONE

Componente: CUNETTA tipo H

Materiali da imp.:

Cls. RcK 350 kg/cm²

Acciaio B450C

peso Kg. 600 (circa)

Vista in Sezione

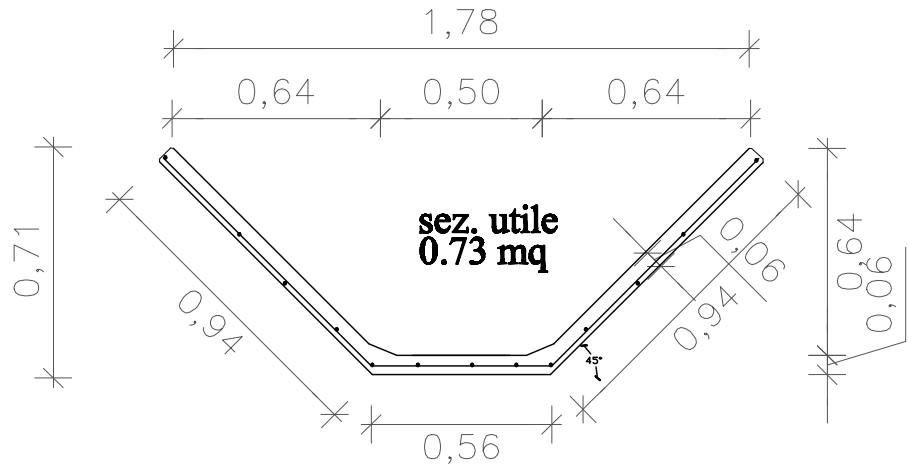

Dettaglio Armatura

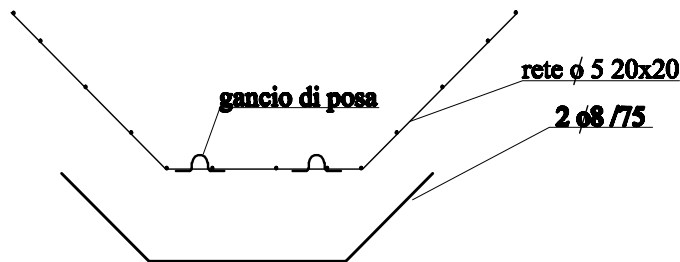

Vista Assonometrica

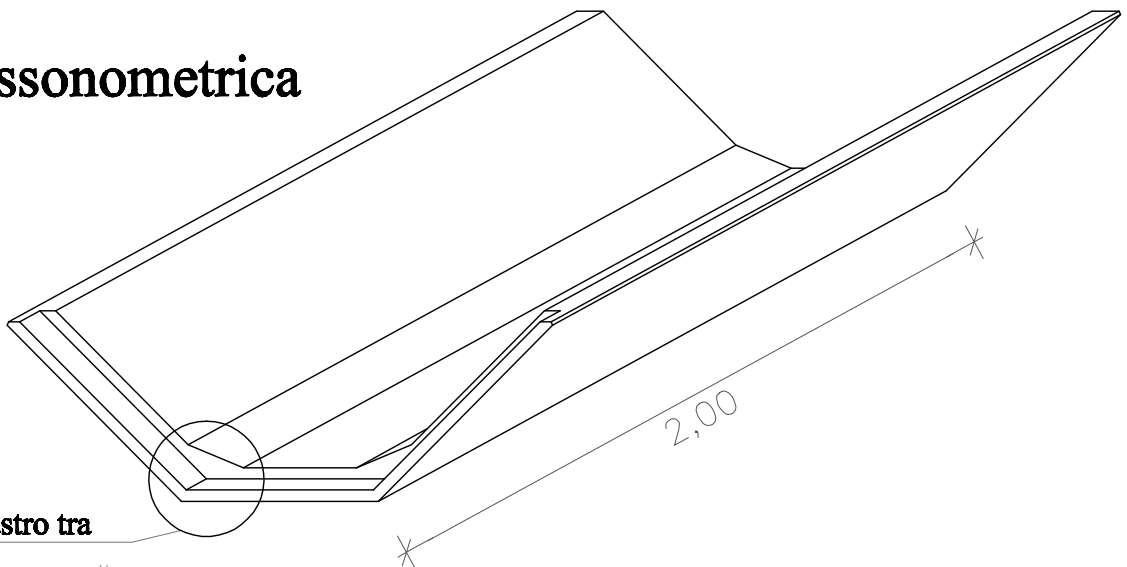

Particolare incastro tra elementi

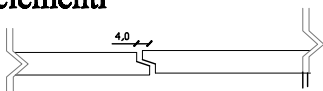

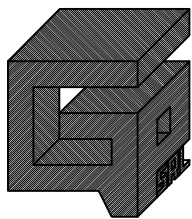

GENERAL PREFABBRICATI S.r.l.

Settore: PREFABBRICAZIONE

Componente: DOPPIA LASTRA RIV. IN PIETRA

Materiali da imp.:

Cls. RcK 350 kg/cmq

Acciaio B450C

VISTA ASSONOMETRICA

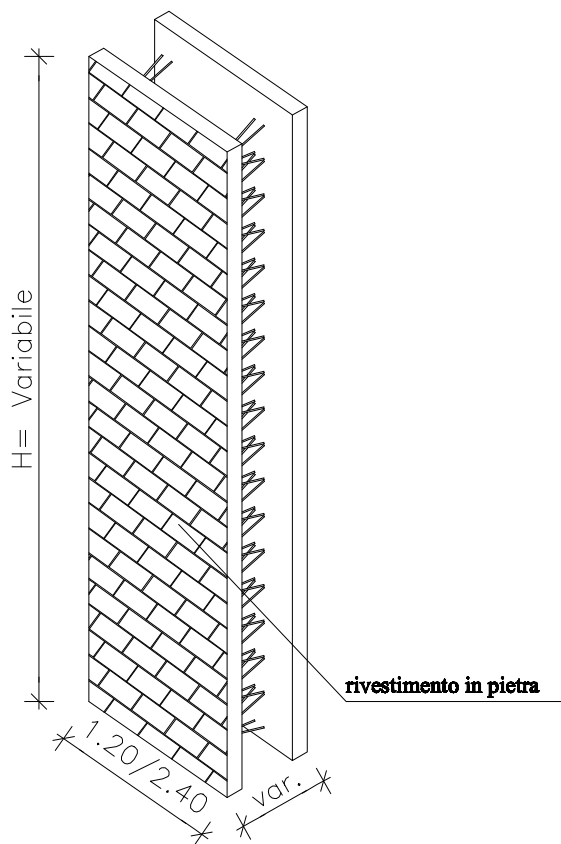

TIPI DI COLLEGAMENTO

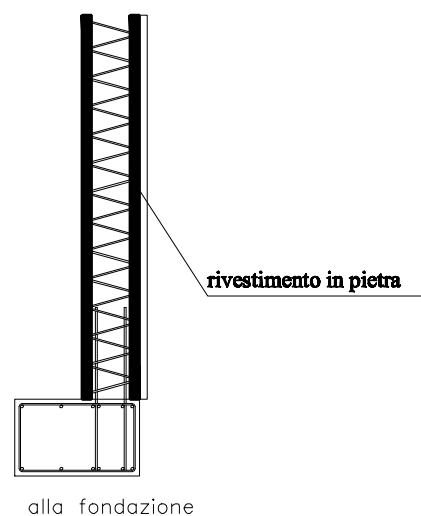

SEZIONI ORIZZONTALI

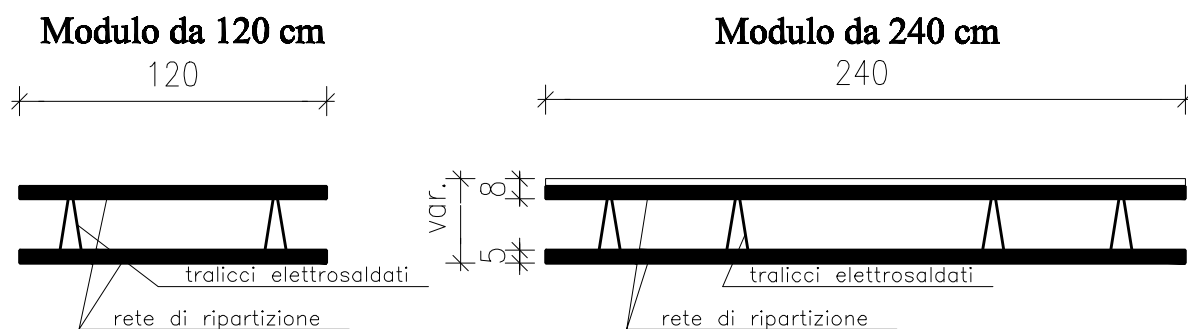

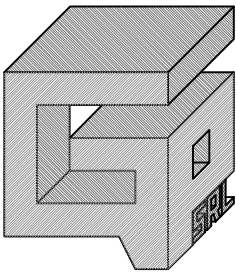

GENERAL PREFABBRICATI S.r.l.

Settore: PREFABBRICAZIONE

Componente: DOPPIA LASTRA

VISTA ASSONOMETRICA

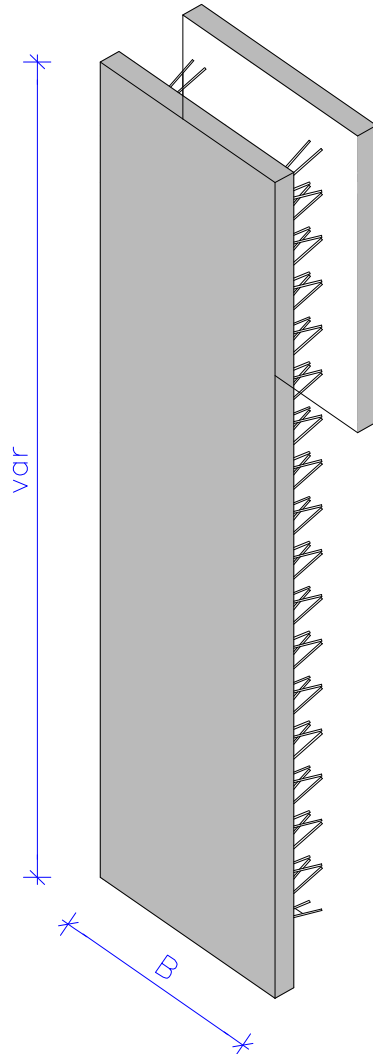

CARATTERISTICHE:

- base B da 120 cm
- spessore S da 20/25/30/35/40 cm
- H variabile
- armatura di base con tralici elettrosaldati e rete di ripartizione

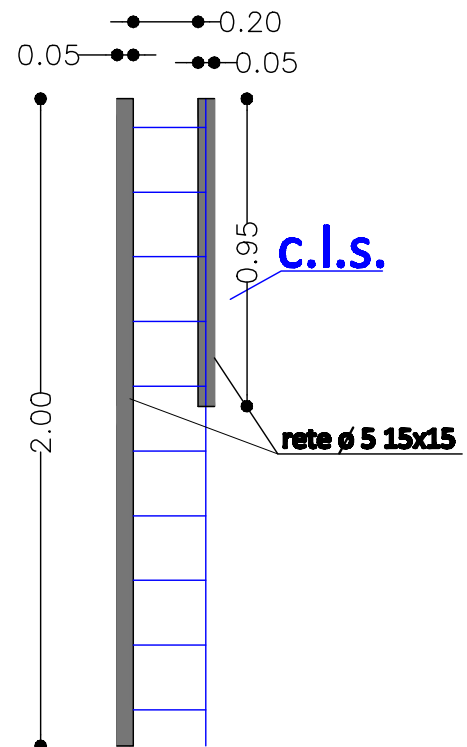

SEZIONI ORIZZONTALI

Modulo da 120 cm

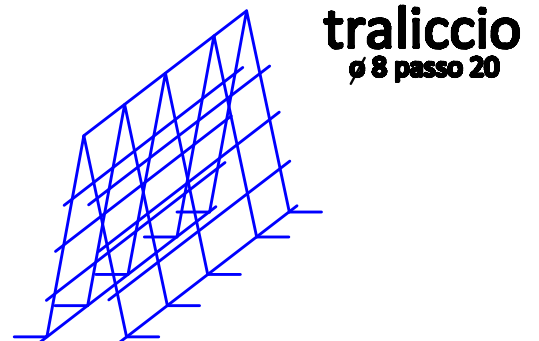
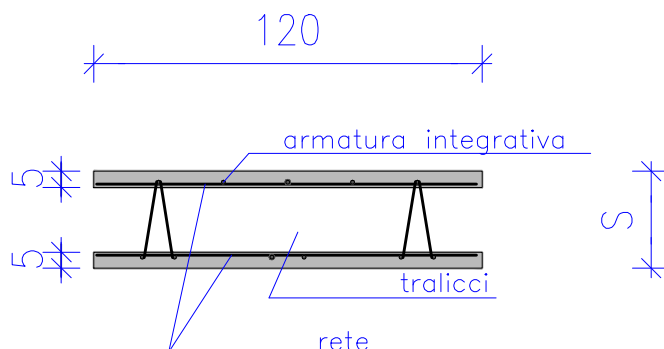

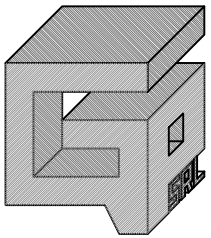

GENERAL PREFABBRICATI S.r.l.

Settore: PREFABBRICAZIONE

Componente: DOPPIA LASTRA

VISTA ASSONOMETRICA

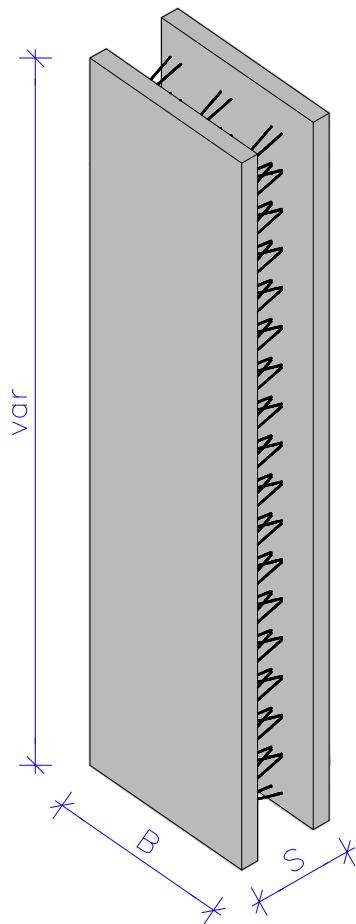

CARATTERISTICHE:

- base B da 120 e 250 cm
- spessore S da 20/25/30/35/40 cm
- H variabile
- armatura di base con tralici elettrosaldati e rete di ripartizione
- peso c.ca 130 kg/mq per lastra

TIPI DI COLLEGAMENTO

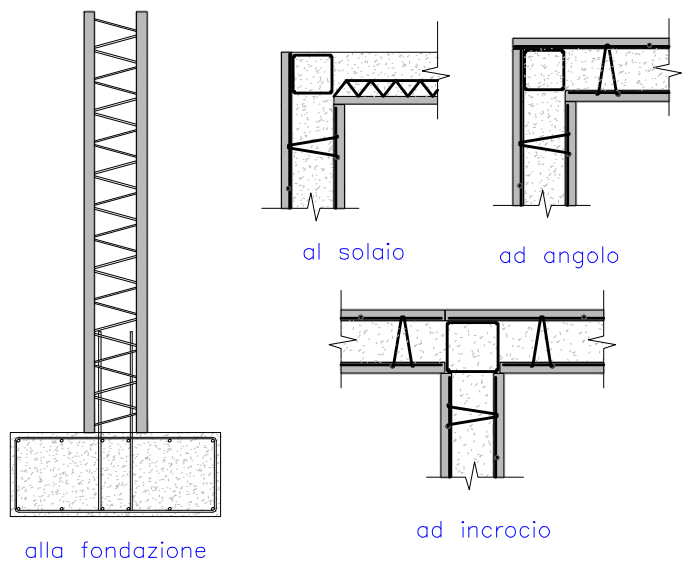

SEZIONI ORIZZONTALI

Modulo da 120 cm

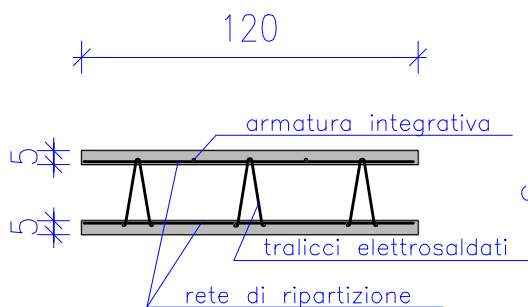

Modulo da 250 cm



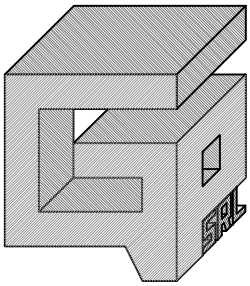

GENERAL PREFABBRICATI S.r.l.

Settore: PREFABBRICAZIONE

Componente: LASTRA SAGOMATA

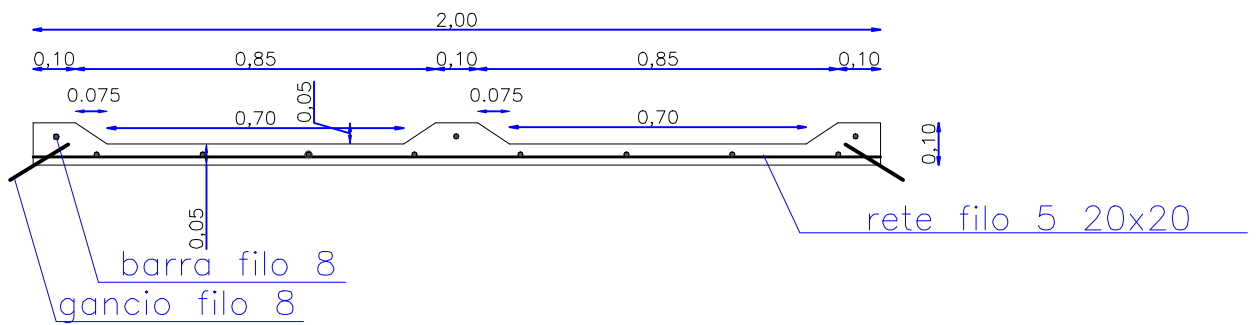
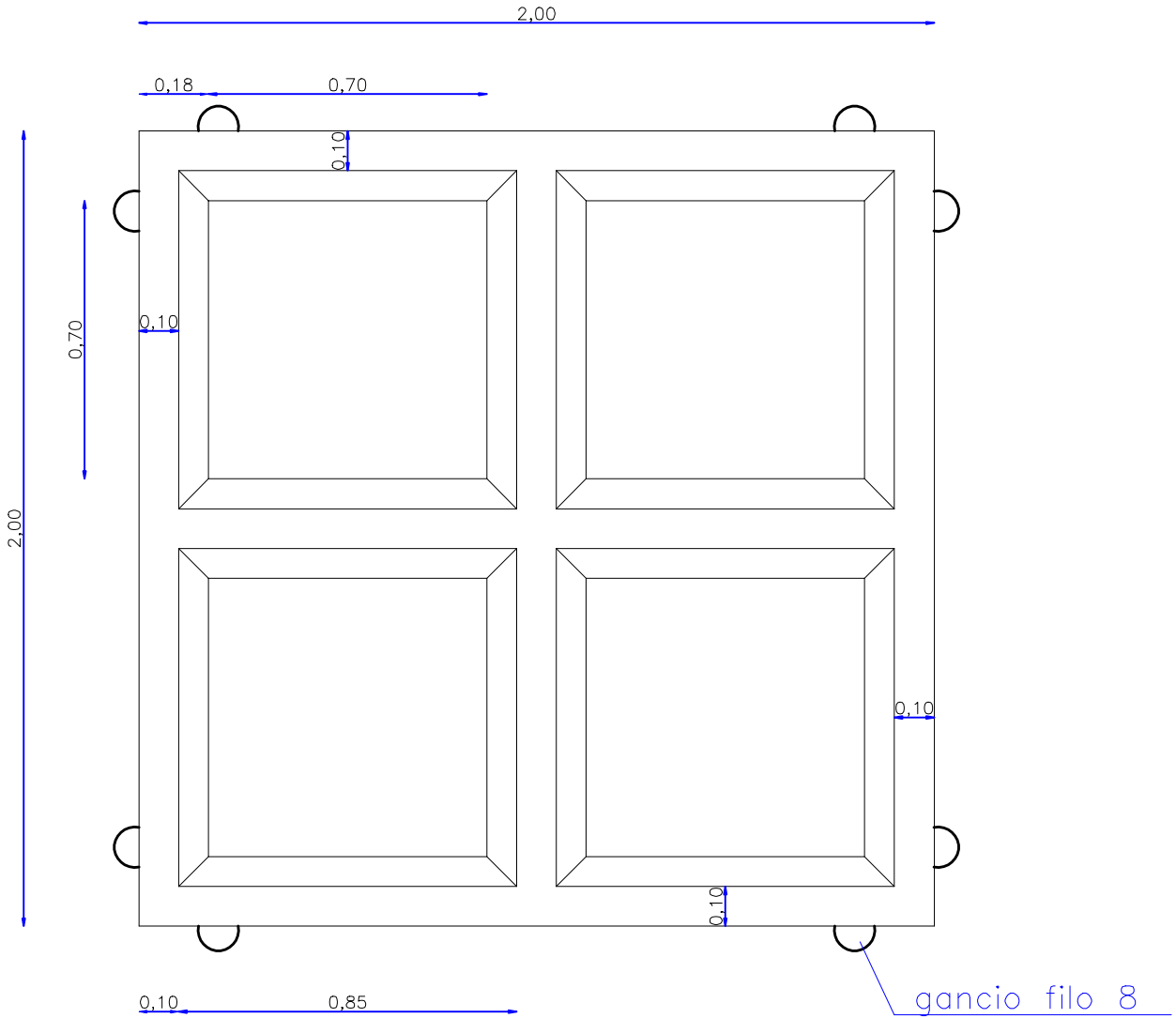

mc 0.27

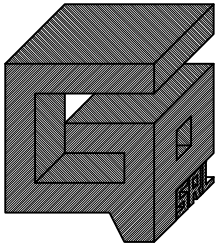

GENERAL PREFABBRICATI SRL

Oggetto: MURI DI SOSTEGNO
250X H275

Commissione:

Data:
01-10-2015

ALL. 09/10
REV. 0

Redatto da: geom.
Walter Lombardella

Approvato da:
Perretta Antonino

Sigla:
M_T

Quantità:

Volume
calcestruz.:
mc 3.03

Peso:
q.li 75.75

VISTA ASSONOMETRICA

foro da 42 per il sollevamento

foro da 20 per ancoraggio

carico di 2000 kg/mq
riempimento materiale arido

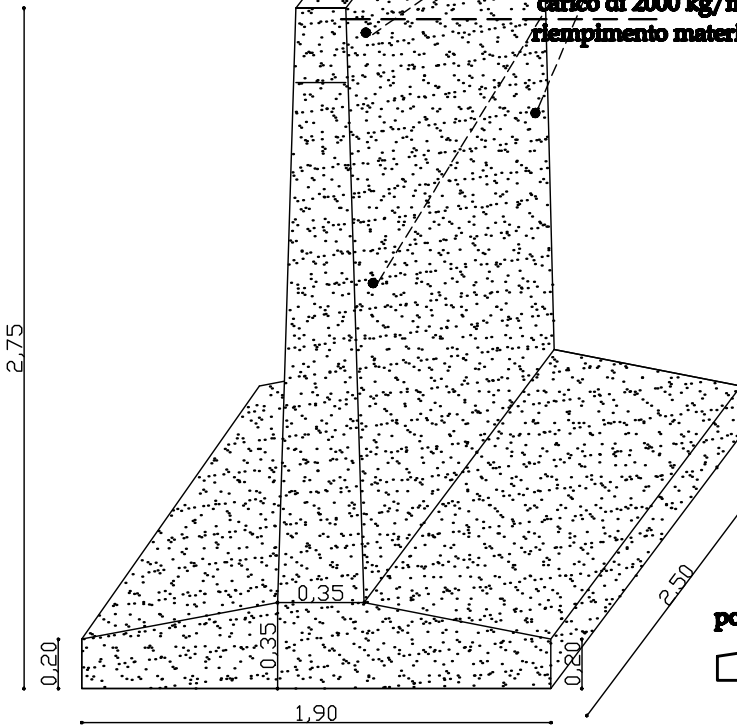

SEZIONE

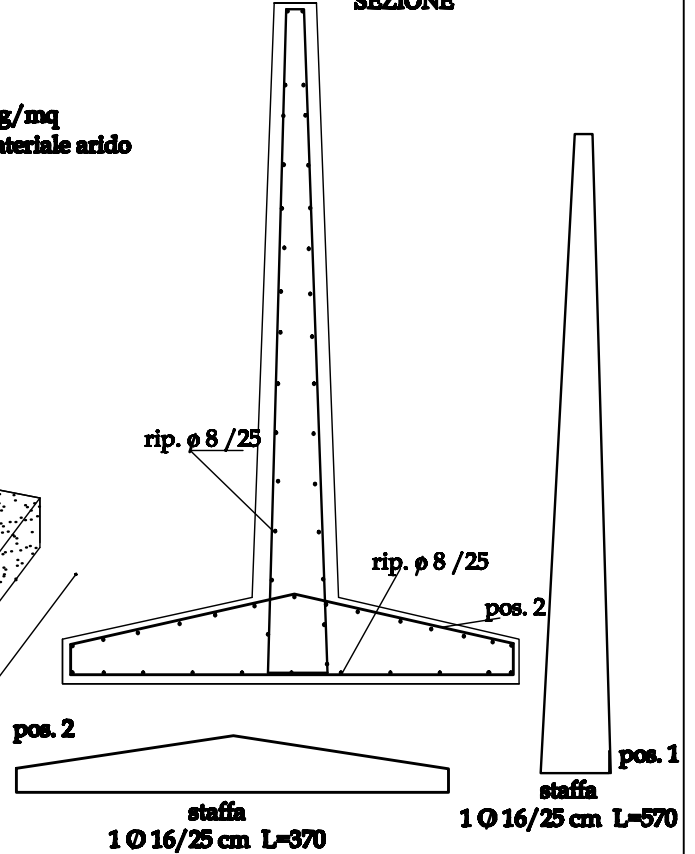

PROSPETTO FRONTALE

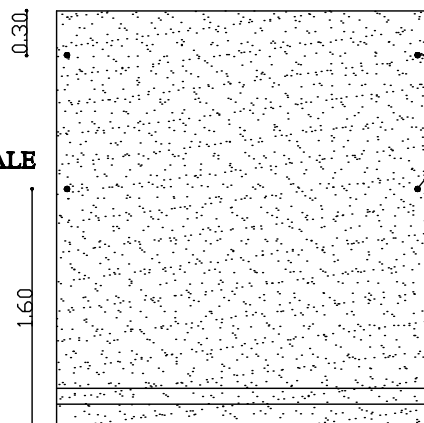

SEZIONE

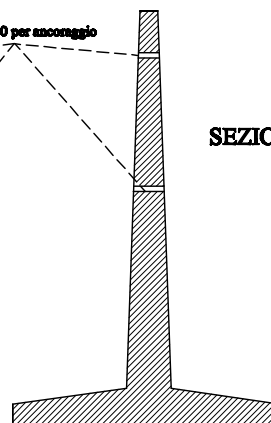

Dimensione:	Progetto:	Reale:	Differenza:	St:	No:	Classe di resistenza cis. a 28 gg.: $R_{ck} \geq 35 \text{ N/mm}^2$ (C32/40)	Classe di consistenza: S4
Larghezza (cm)	250					Classe di resistenza cis. allo scasso: $R_{ck} \geq 20 \text{ N/mm}^2$ (C16/20)	Rapporto A/C: = 0,51
Altezza (cm)	275					Classe di esposizione EN 206-1: XA2	Aggregato ϕ max: 16 mm
Spessore (cm)	20/35					ACCIAIO: B460C	
						REI:	
						Copriferro: distanziatore altezza mm 35	
						Tolleranze di produzione (UNI EN 13369:2008). Definizione di tolleranza: è definita come la differenza tra le due dimensioni limite, minima e massima ($\pm \Delta L$), in riferimento a quella assegnata al manufatto: Lunghezza/larghezza fino a mm 1000 $\pm \Delta L = 10 \text{ mm}$ Lunghezza/larghezza oltre mm 1000 $\pm \Delta L = 9 + L/1000 \text{ (mm)}$ Spessori "t" e misura corte (fino a mm 1.000) $\pm \Delta t = 10 \text{ mm}$ Rettilineità "j" in qualsiasi piano principale: $\pm \mu = L/700 \text{ (mm)}$ Squadratura "v" e misure angolari: $\pm \delta = 1/1000 \text{ (mm)}$	

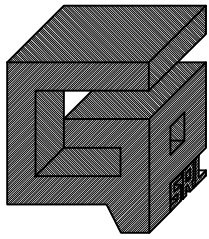

GENERAL PREFABBRICATI S.r.l.

Settore: PREFABBRICAZIONE

Componente: New Jersey 200 x H40

Materiali da imp.:

Cls. RcK 450 kg/cm²

Acciaio B450C

Peso circa 650 kg

Prospetto

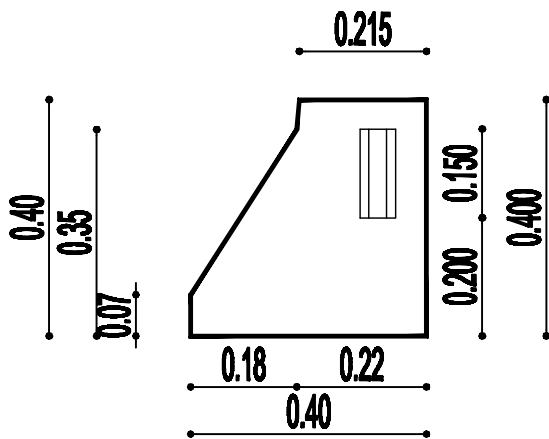

Armatura

rete elettro $\phi 5(10 \times 10)$

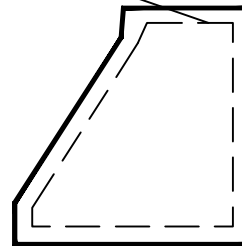

Vista assonometrica

VISTA FRONTALE

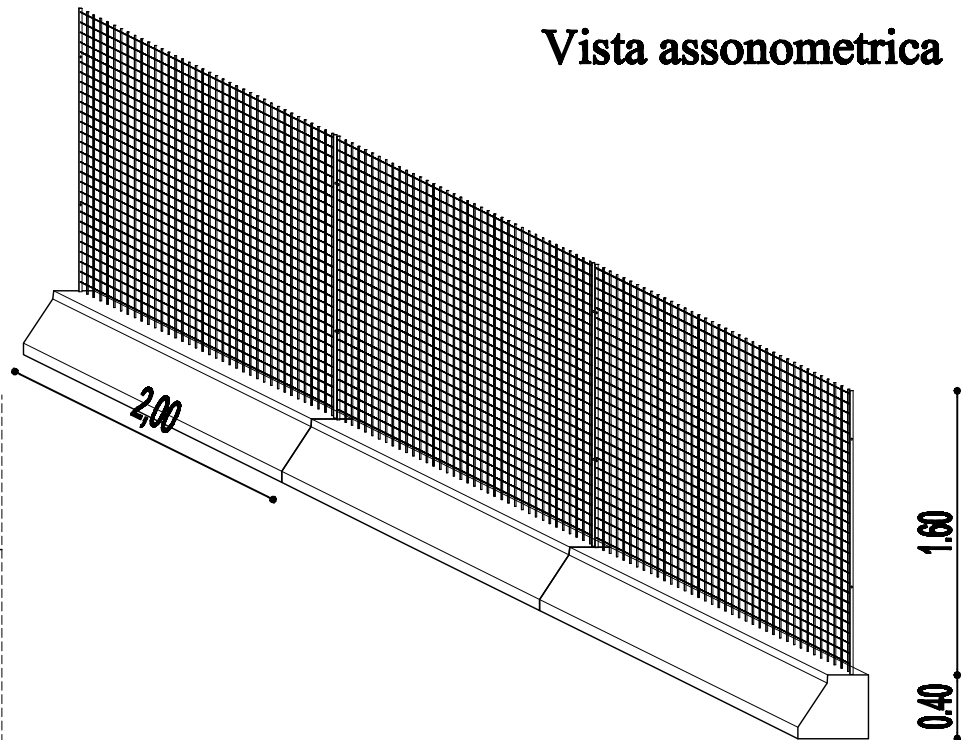
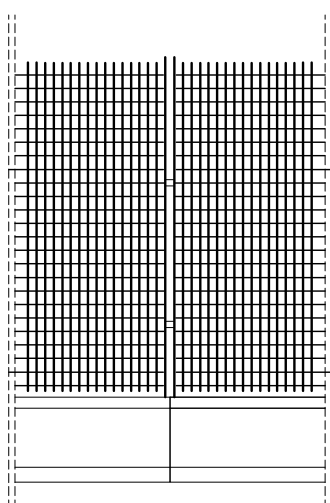

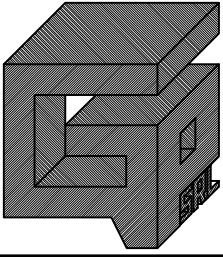

GENERAL PREFABBRICATI S.r.l.

Settore: PREFABBRICAZIONE

Componente: New Jersey "tipo 2"

Materiali da imp.:

Cls. RcK 450 kg/cmq

Acciaio B450C

Peso circa 3500 kg

Prospetto

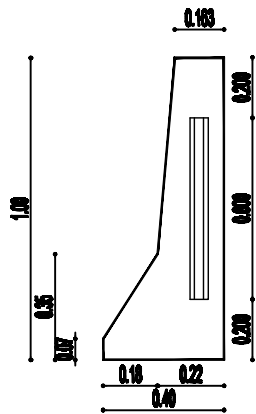

Armatura

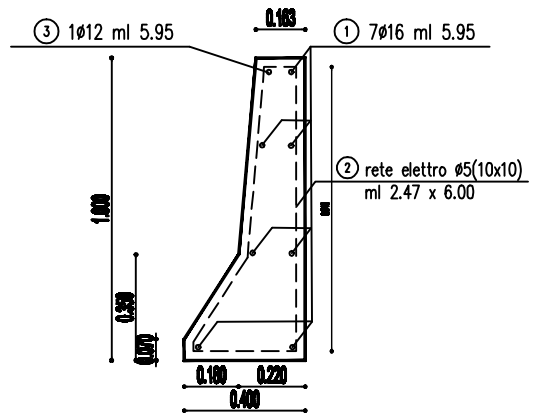

Vista assonometrica

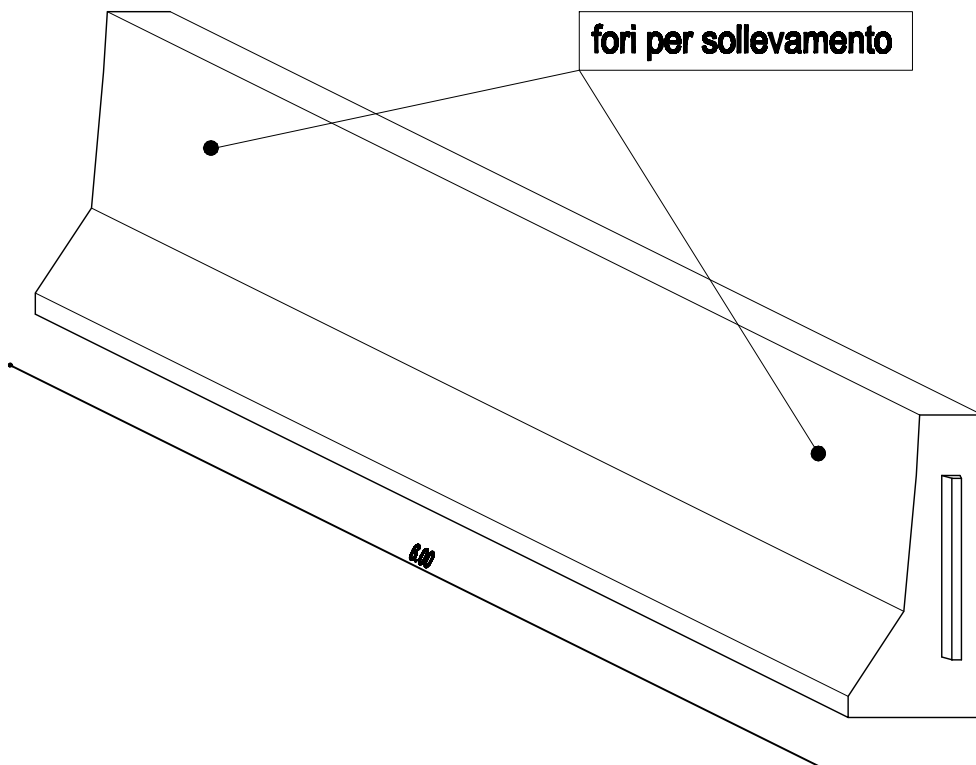

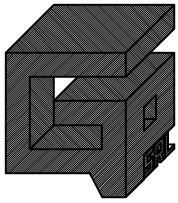

GENERAL PREFABBRICATI S.r.l

Settore: PREFABBRICAZIONE

Componente: NEW JERSEY

Materiali da imp.:
Cls. RcK 450 kg/cmq
Acciaio B450C
Peso circa 3500 kg

PIANTA - Scala 1:10

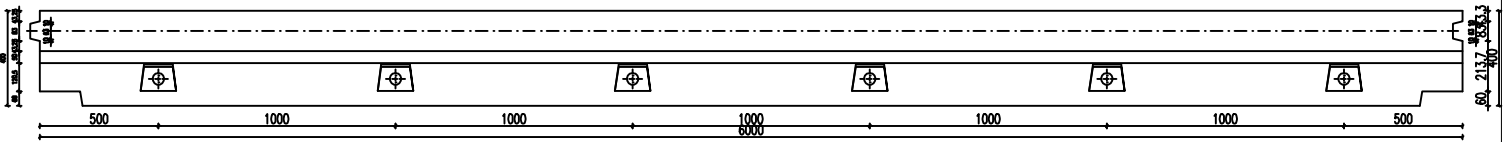

PROSPETTO FRONTALE - Scala 1:10

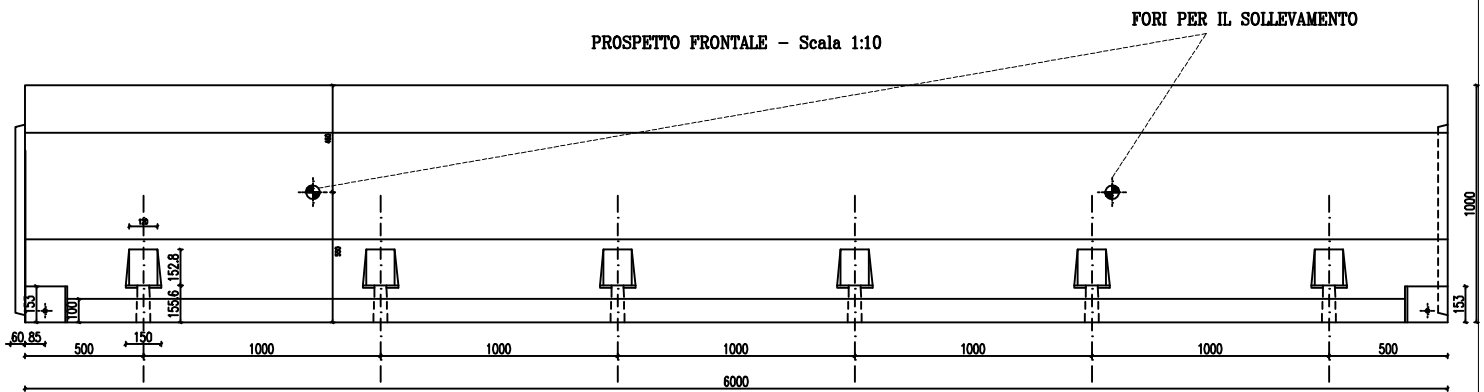

VISTA LATERALE SUL GIUNTO
Scala 1:10

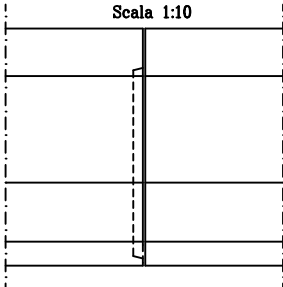

ANCORAGGIO
PROFILO - Scala 1:10

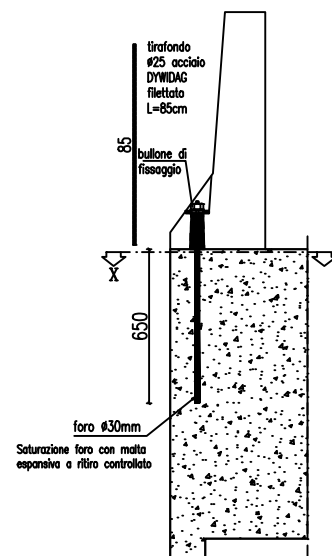

PROSPETTO LATERALE
Scala 1:10

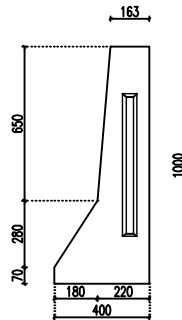

Armatura

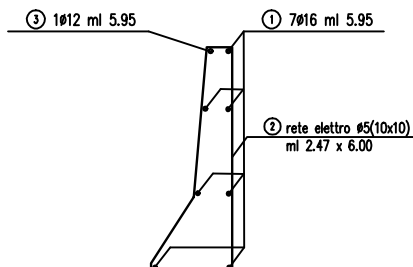

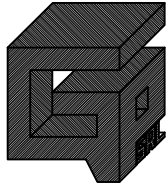

GENERAL PREFABBRICATI S.r.l.

Settore: PREFABBRICAZIONE

Componente: NEW JERSEY

Materiali da imp.:

Cls. RcK 450 kg/cmq

Acciaio B450C

Peso circa 3500 kg

Prospetto

Armatura

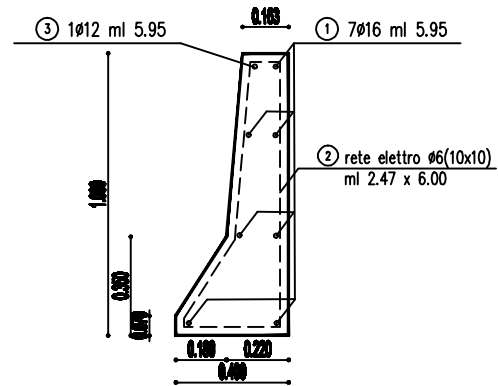
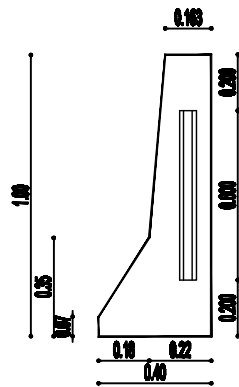

Vista assonometrica

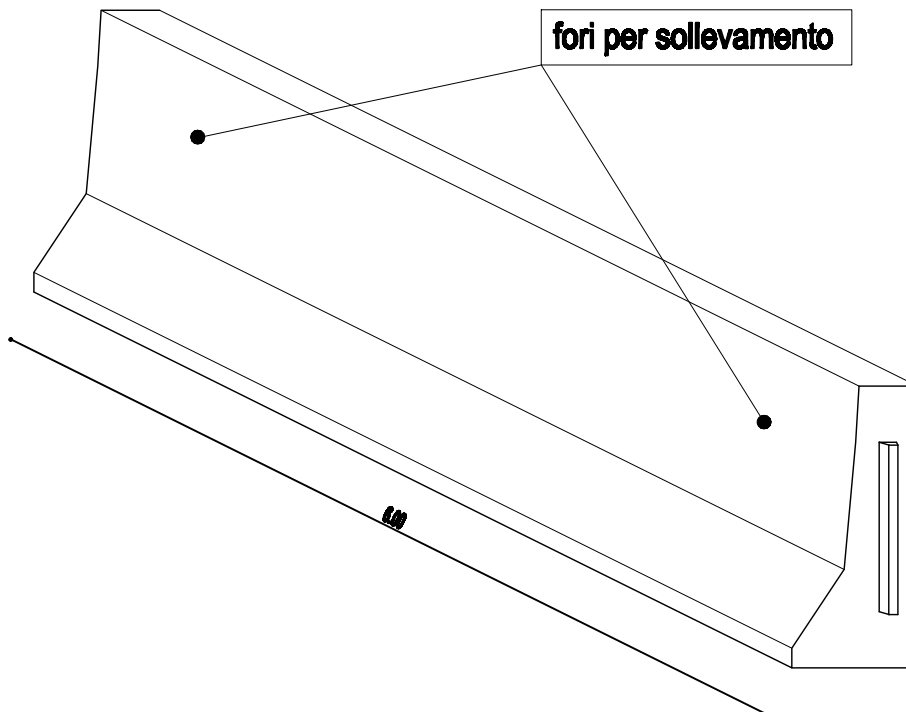

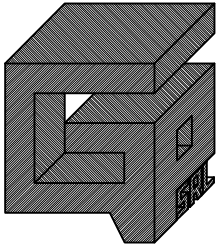

GENERAL PREFABBRICATI S.r.l.

Settore: PREFABBRICAZIONE

Componente: New Jersey tipo centrale

Materiali da imp.:

Cls. RcK 450 kg/cmq

Acciaio B450C

Prospetto

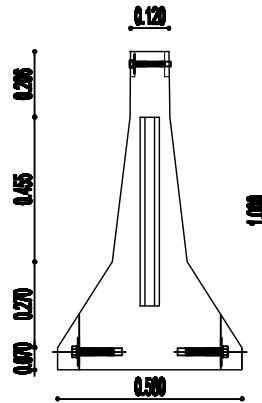

Vista assonometrica

Fori di sollevamento

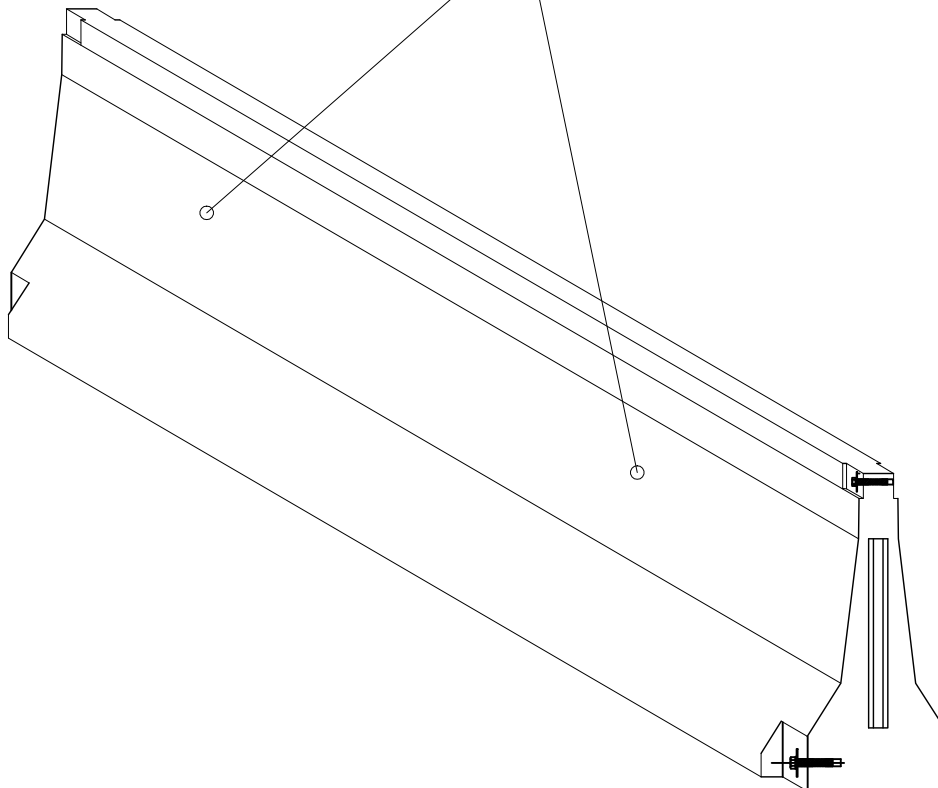

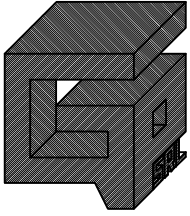

GENERAL PREFABBRICATI S.r.l.

Settore: PREFABBRICAZIONE

**Componente: OSSARIO DOPPIO FRONTALE DI DIMENSIONI INETRNE
cm 30X30XL75**

SCHEDA TECNICA

RESISTENZA DEL CLS : ≥ 30 Mpa
CEMENTO IMPIEGATO : UNI ENV 197/1 TIPO 42.5
RAPPORTO AC : $\approx 0,42$
TECNOLOGIA DI PRODUZIONE : VIBRAZIONE
TECNOLOGIA DI PRODUZIONE : VIBRAZIONE

Pianta

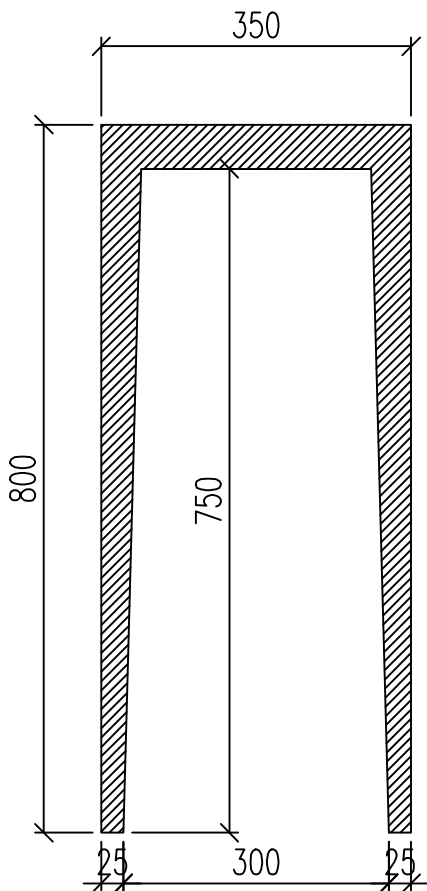

Prospetto

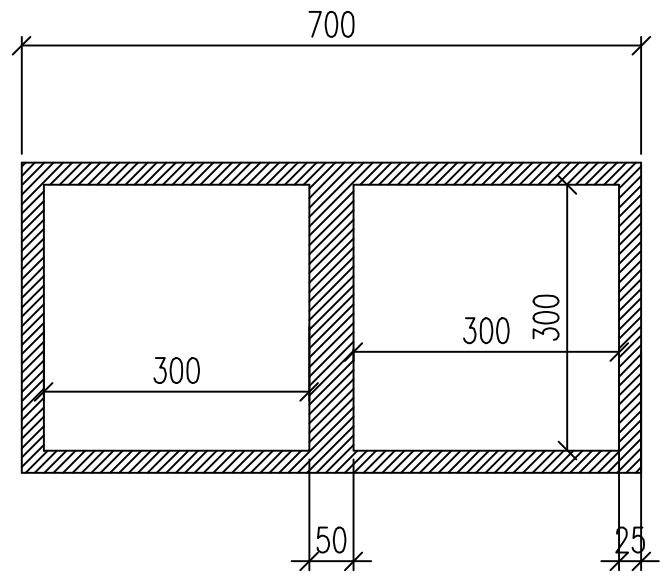

Sezione

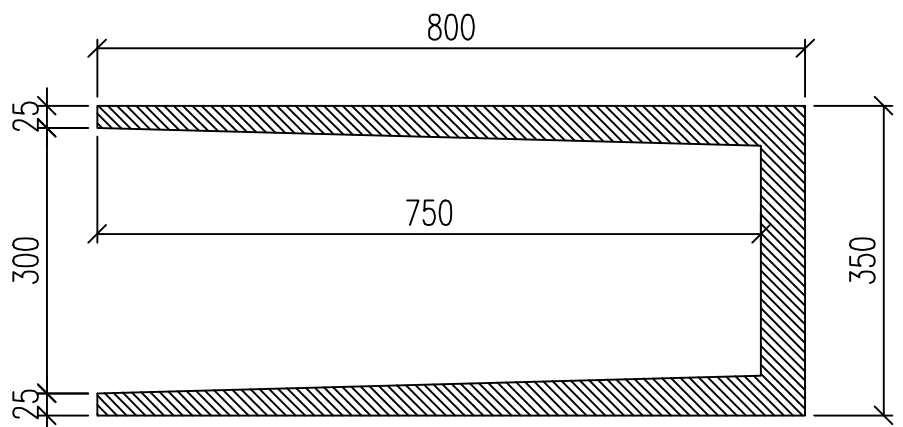

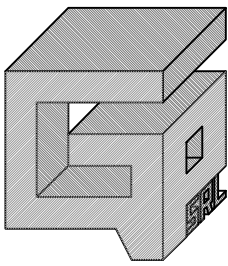

GENERAL PREFABBRICATI S.r.l.

Settore: PREFABBRICAZIONE

Componente: LASTRA TRALICCIATA

Materiali da imp.:

Cls. RcK 350 kg/cmq

Acciaio B450C

peso Kg. 660 (circa)

1.20

4.40

Vista in Sezione

Armatura con Traliccio 5/7/5 h12.5

Spess. cm 5

Rete Elettrosaldata 19x25 filo5

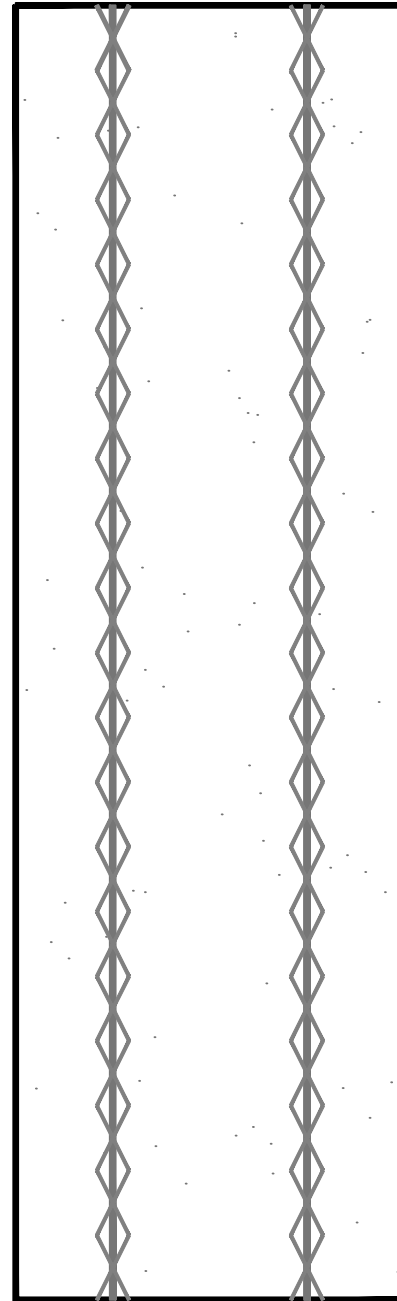
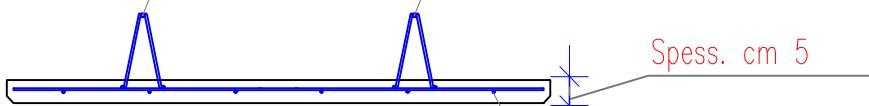

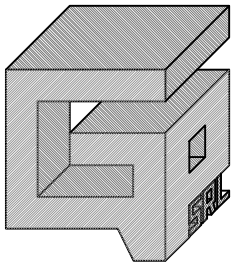

GENERAL PREFABBRICATI S.r.l.

Settore: PREFABBRICAZIONE

Componente: PANNELLI RIVESTITI IN PIETRA DI TRANI

Vista Frontale

Var. 1.20 - 2.40

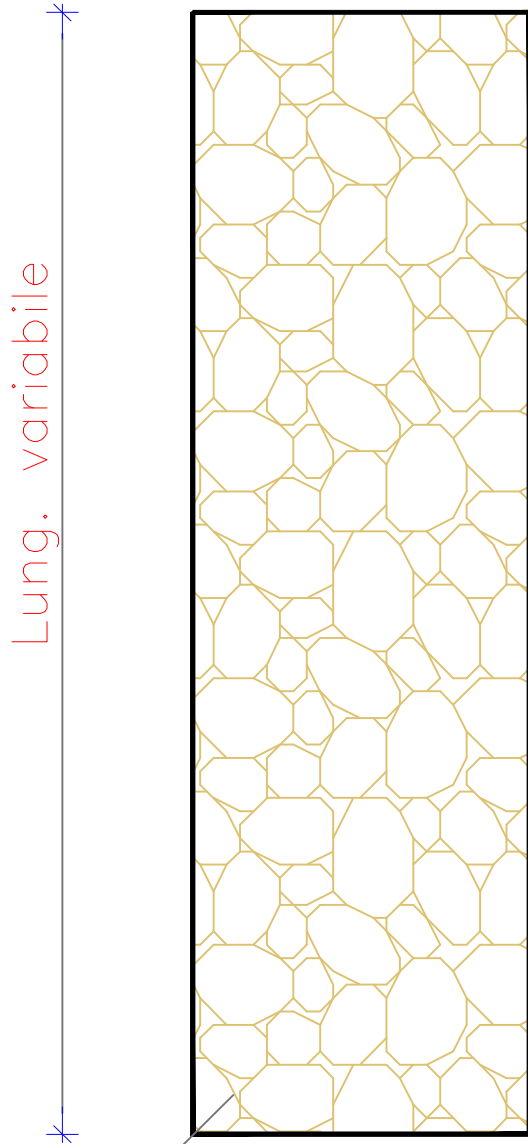

Rives. in pietra di Trani

Vista Posteriore

Var. 1.20 - 2.40

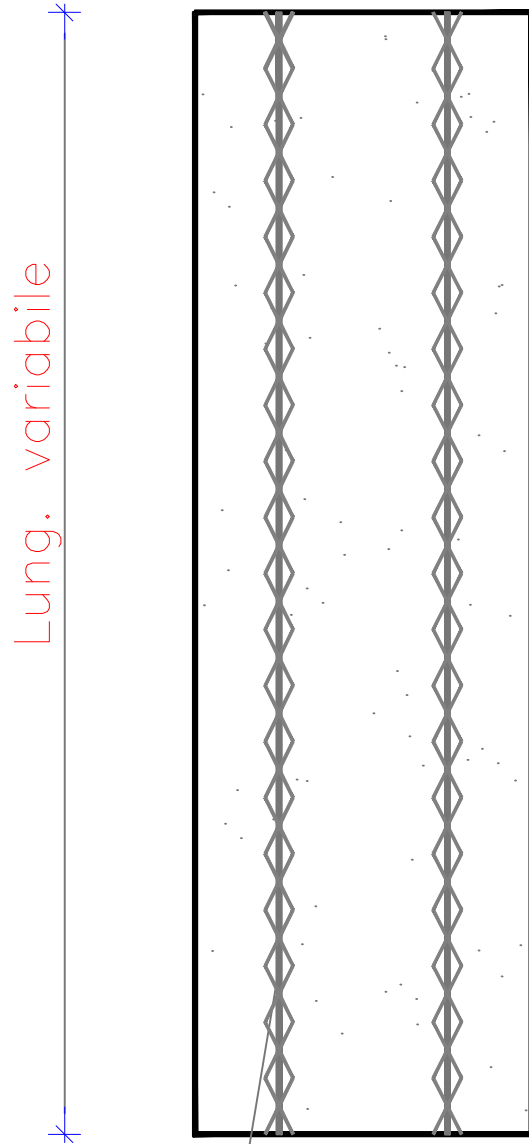

Armatura con Traliccio

Vista in Sezione



Rives. in pietra di Trani

Armatura con Traliccio

Spess. cm 7 - 8

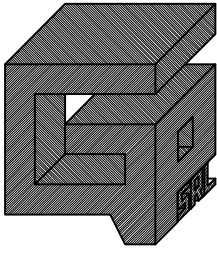

GENERAL PREFABBRICATI S.r.l.

Settore: **PREFABBRICAZIONE**

Componente: **PANNELLI E PILASTRINI PER RECINZIONE**

MATERIALI:

Acciaio per cls armato B450C
Cls Rck 350 Kg/cm²

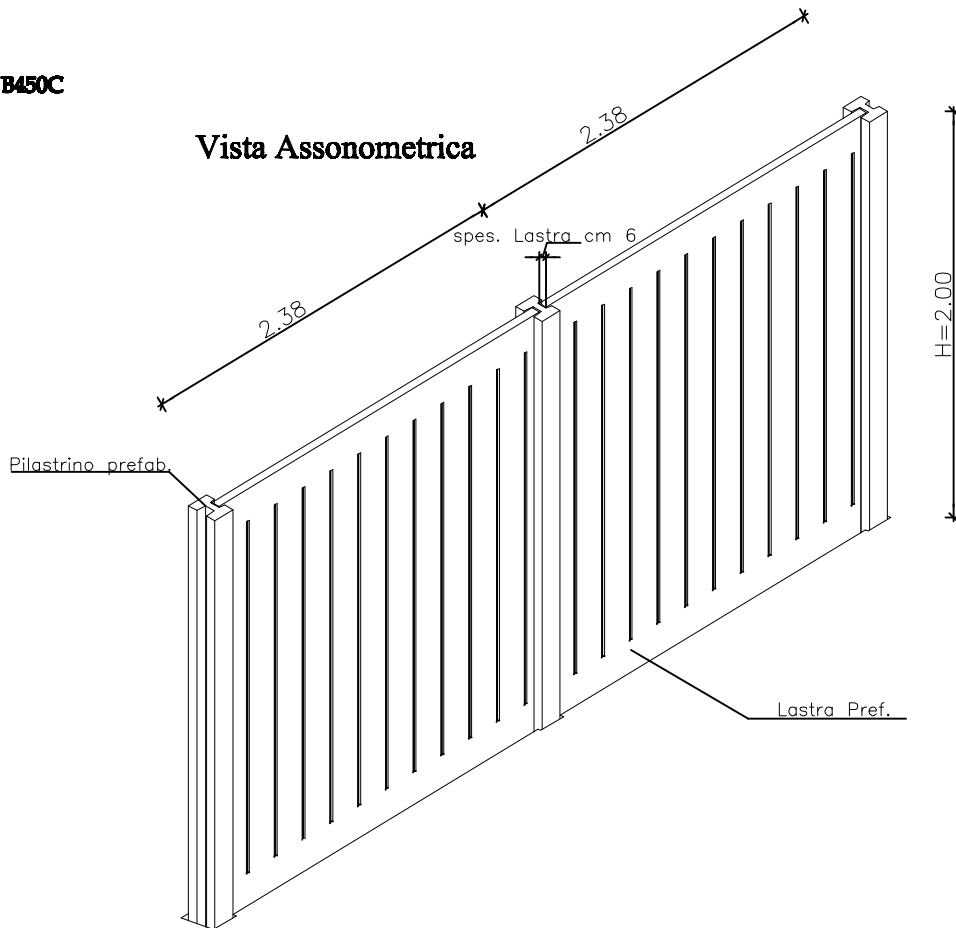

Particolare Lastra prefab. in c.a.v.

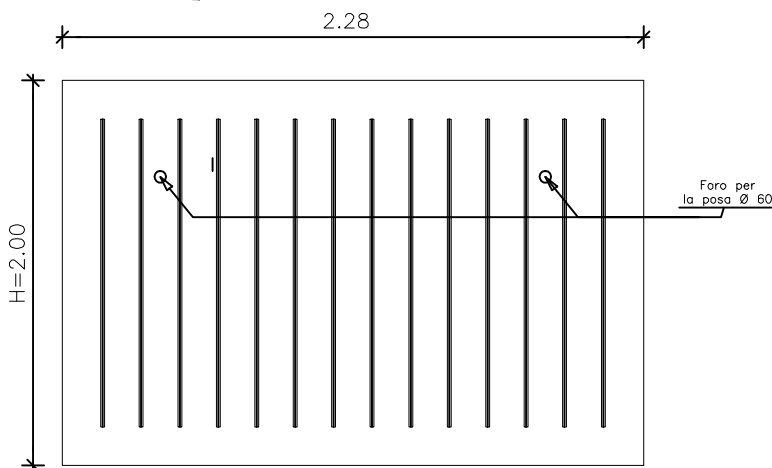

Particolare Pilastrino Pref.

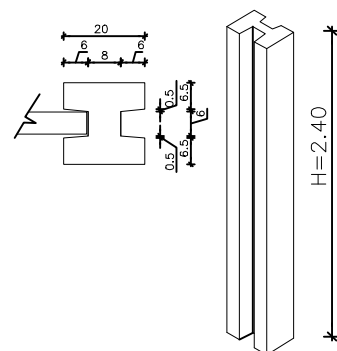

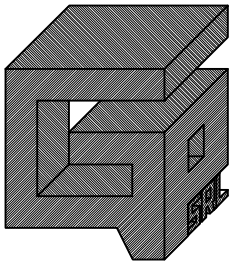

GENERAL PREFABBRICATI S.r.l.

Settore: **PREFABBRICAZIONE**

Componente: **Plinti porta palo 100 x 100 x H100**

PIANTA
SCALA 1:10

ARMATURA SEZIONE
SCALA 1:10

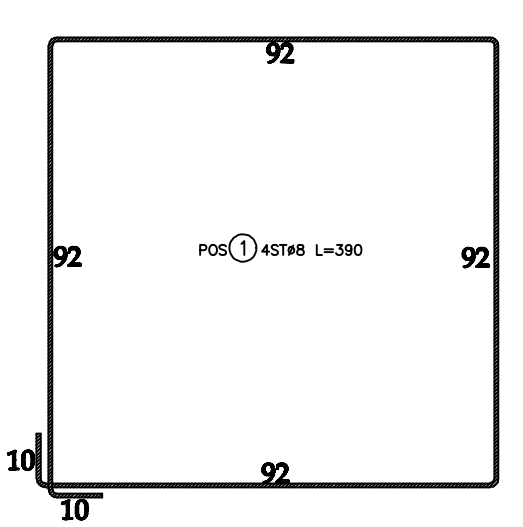
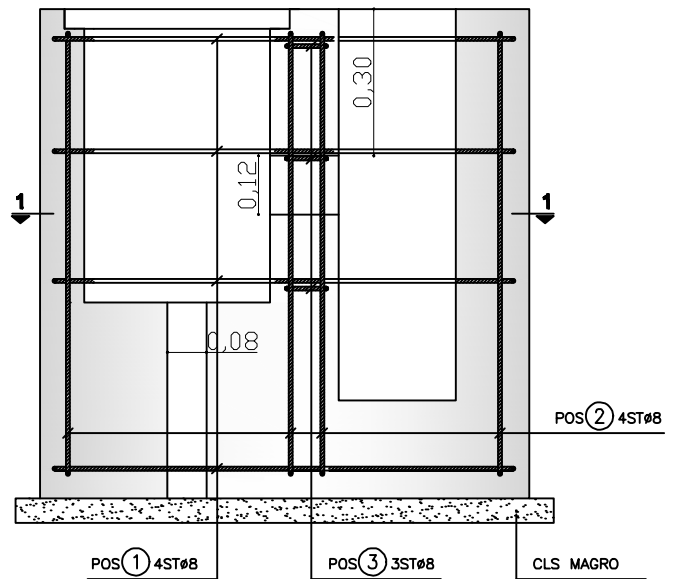
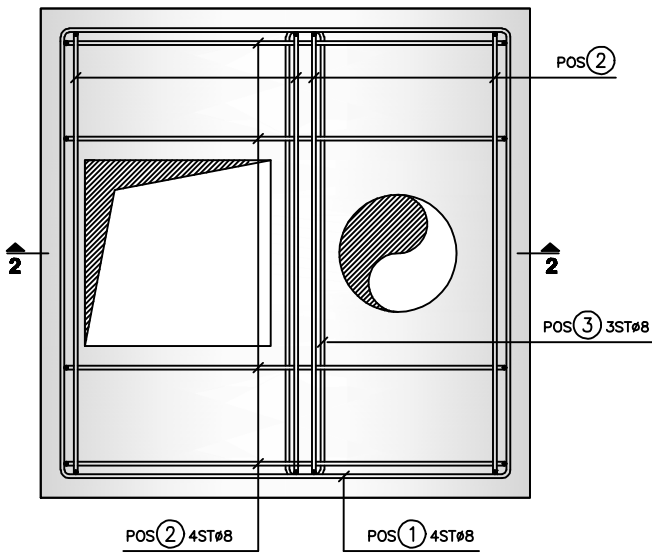

Staffatura Orizzontale

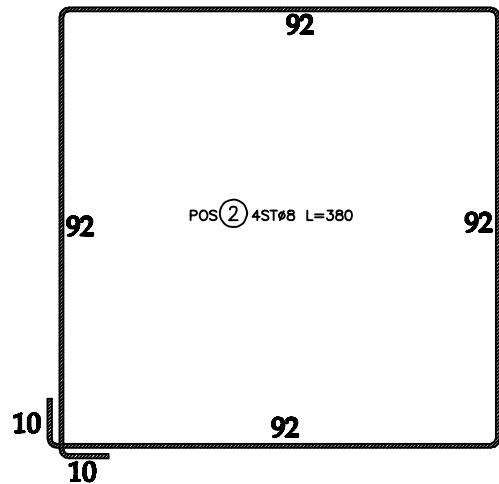
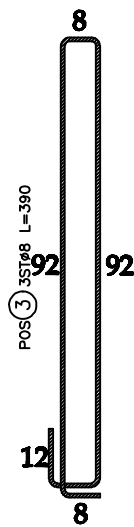

Staffatura Verticale

SEZIONE 1-1
SCALA 1:10

SEZIONE 2-2
SCALA 1:10

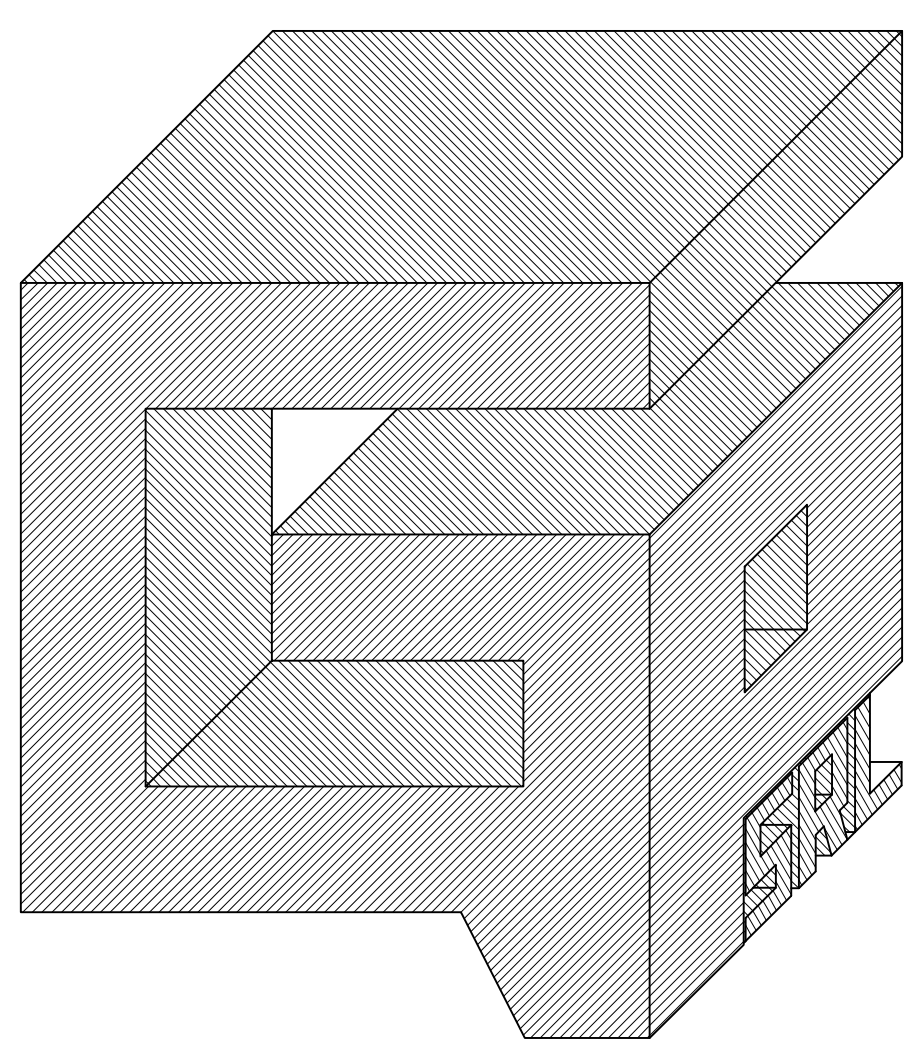

GENERAL PREFABBRICATI S.r.l.

Settore: PREFABBRICAZIONE

Componente: POZZETTO TAGLIA FUOCO

Materiali da imp.:

Cls. RcK 450 kg/cmq

acciaio B450C

peso Kg/ml 620 circa

SEZ. 3-3

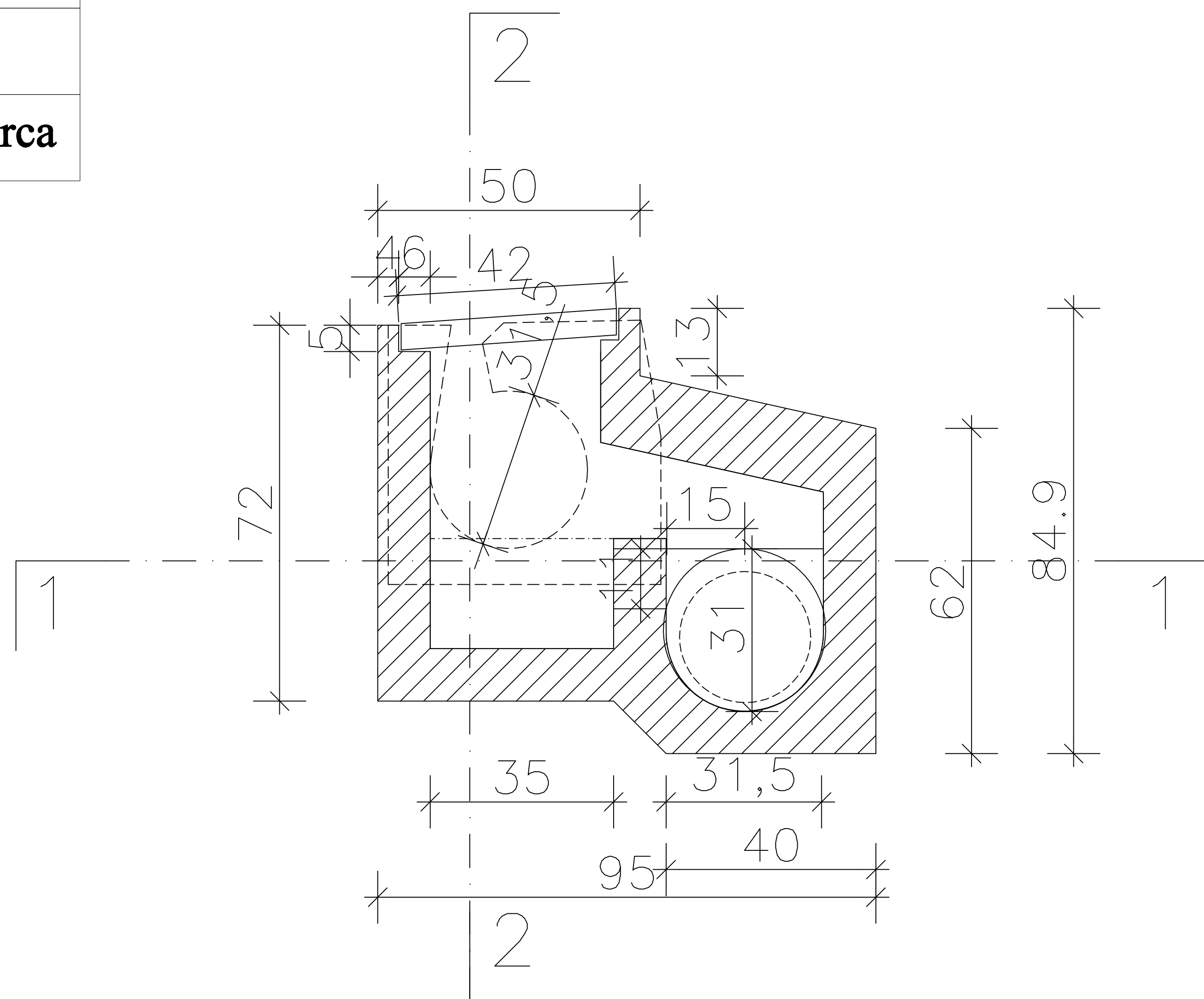

ARMATURA

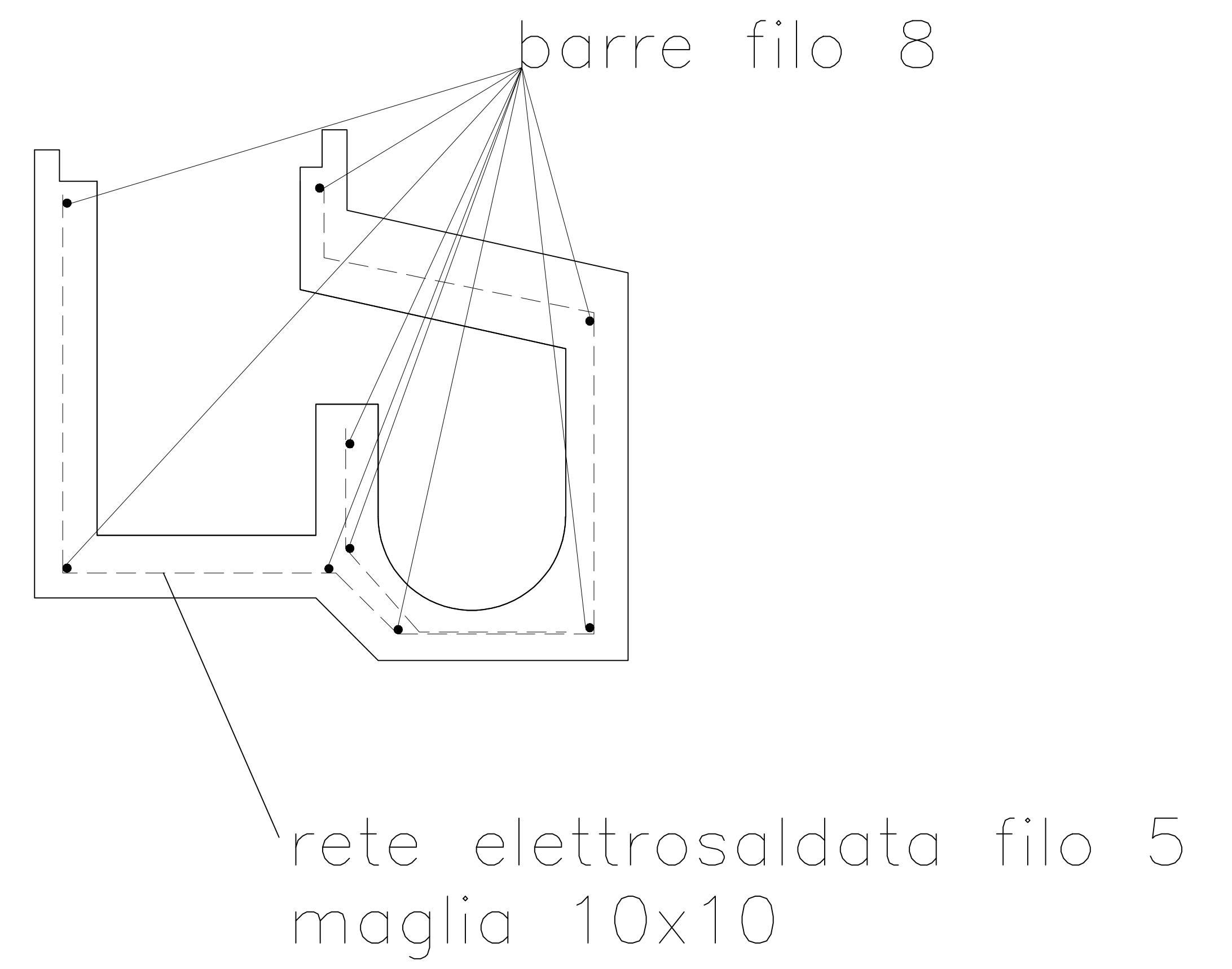

VISTA ASSONOMETRICA

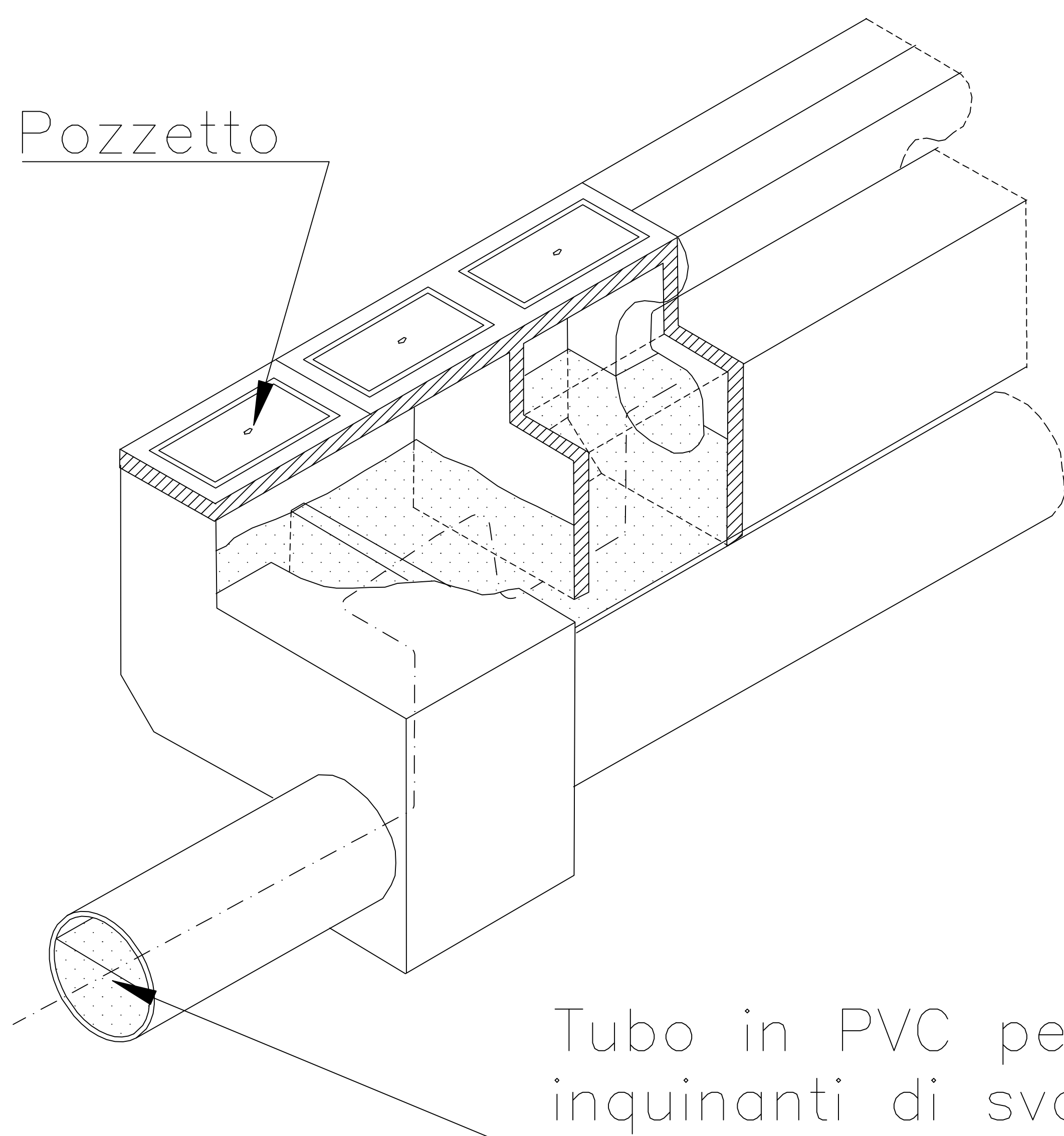

SEZ. 2-2 Copertura carrabile
manufatto prefabbricato
in cls

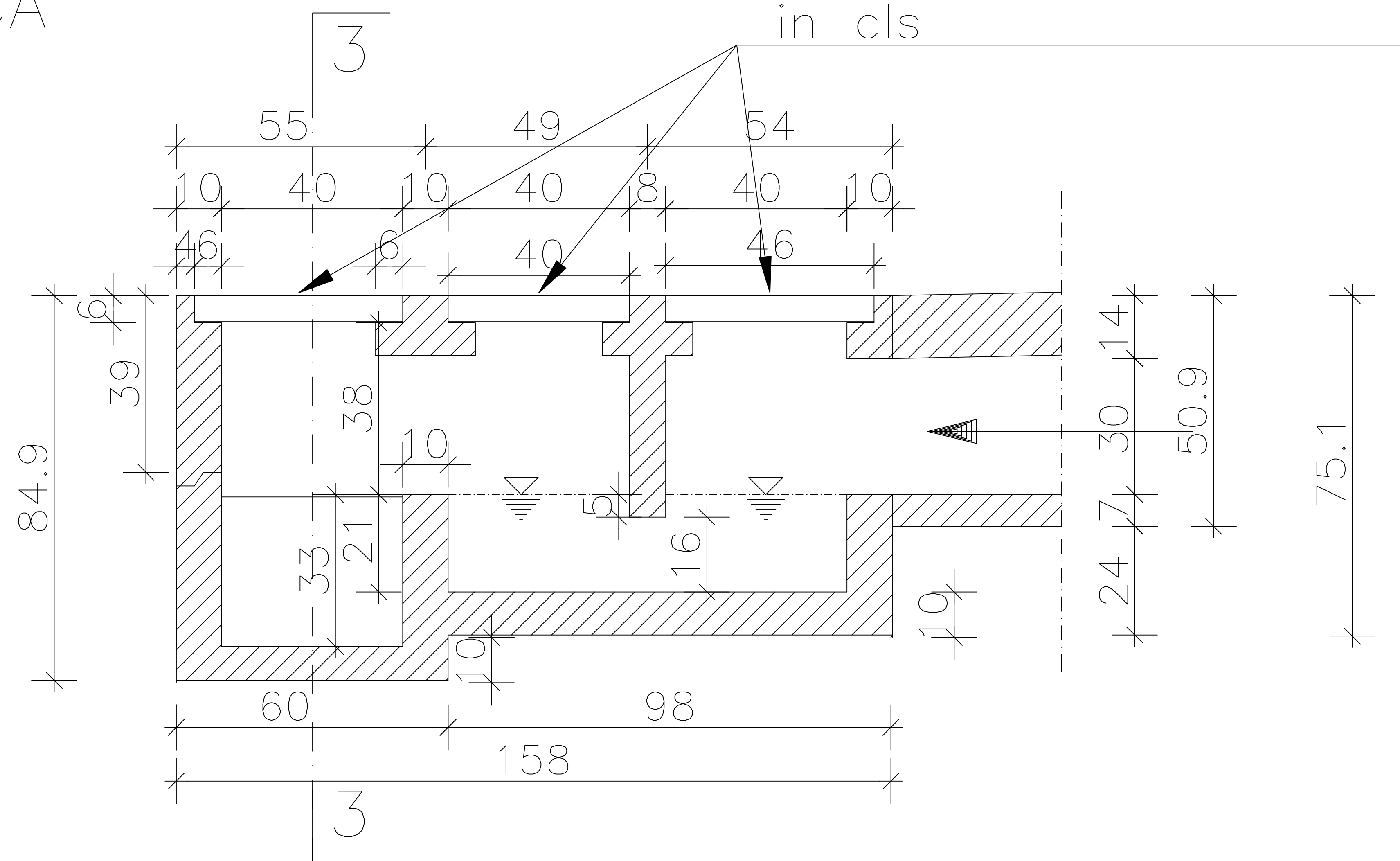

SEZ. 1-1

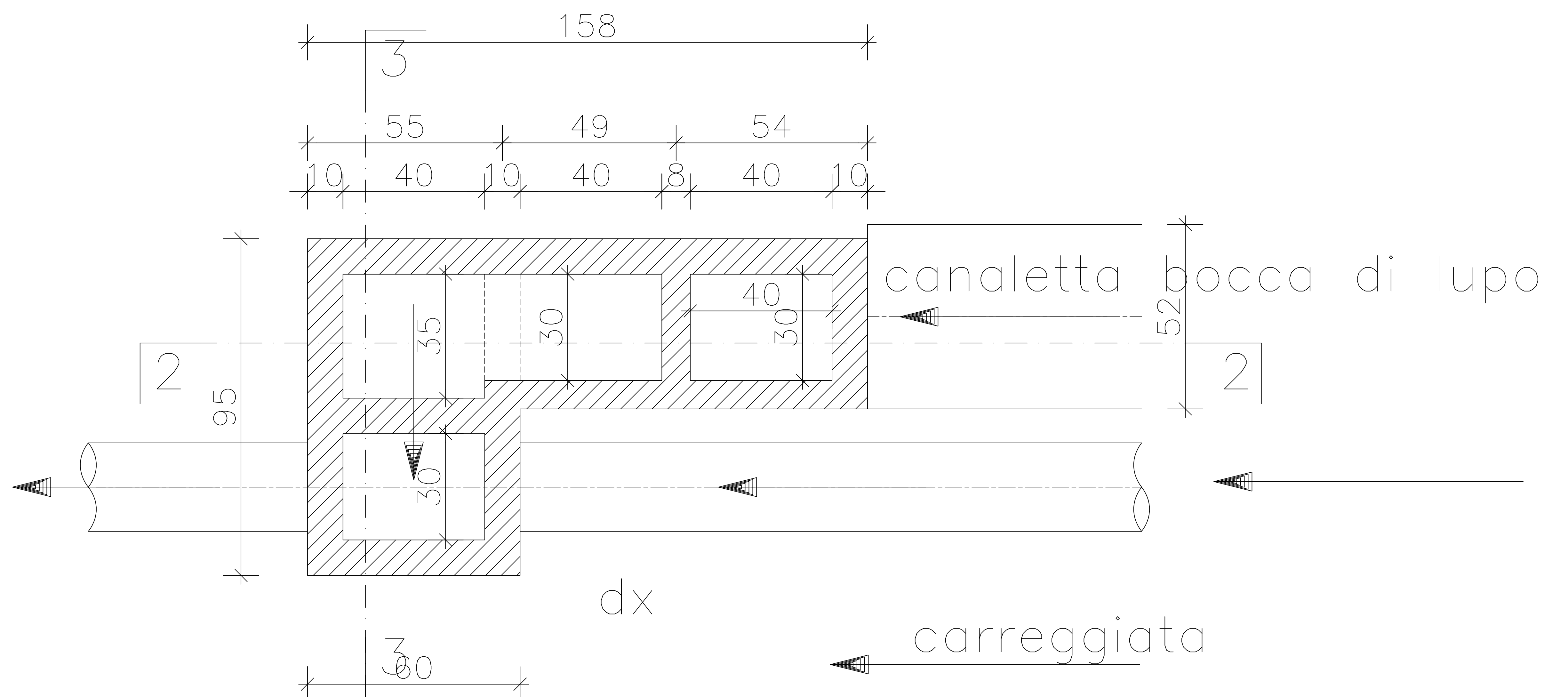

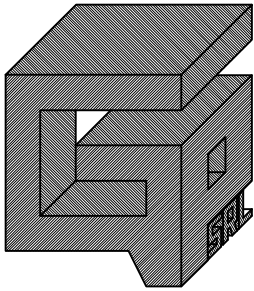

Oggetto: SCATOLARE 250X200

Commissione:

Data:
15-10-2015

ALL. 09/10
REV. 0

Redatto da: geom.
Walter Lambardella

Approvato da:
Perretta Antonino

Sigla:
SC

Quantita':

Volume
calcestruz.:
mc 1.88

Peso:
q.li 47.00

GENERAL PREFABBRICATI S.r.l.

ASSONOMETRIA

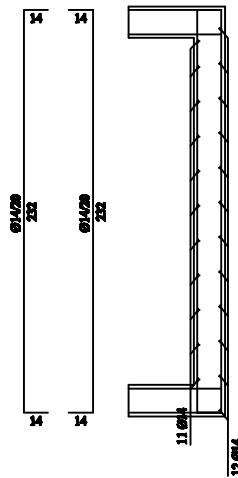
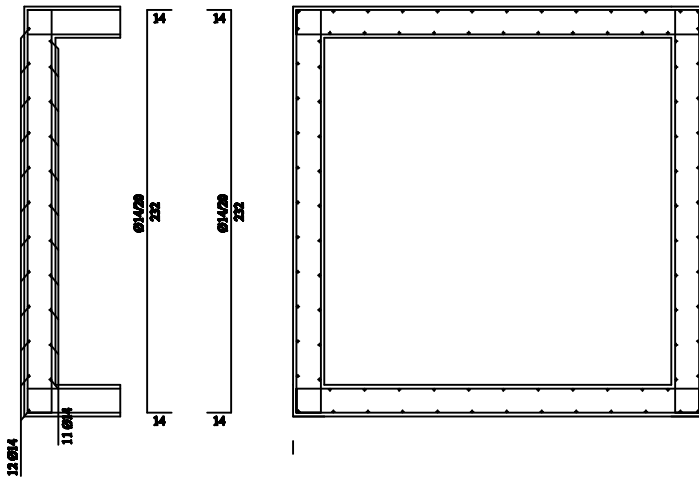
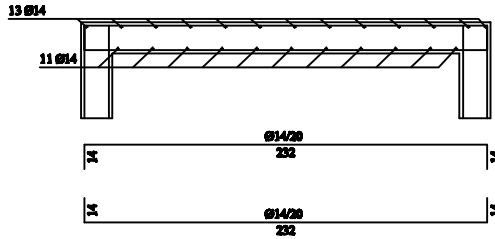
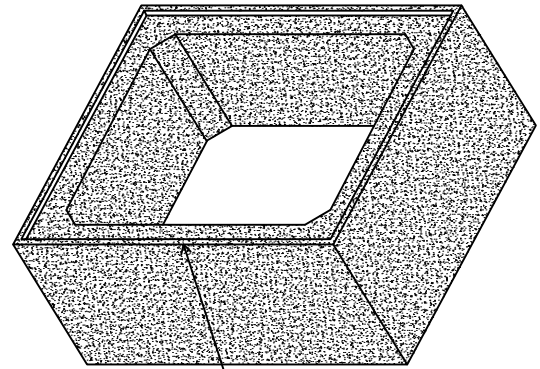

Particolare innoastro

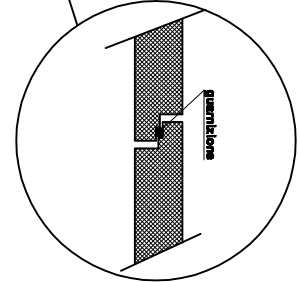

PIANTA

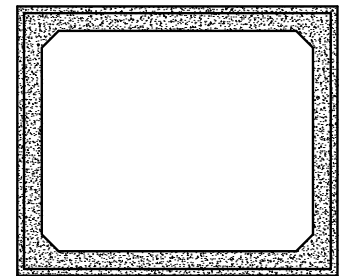

Dimensione:	Progetto:	Resle:	Differenza:	SI:	No:	Classe di resistenza cls. a 28 gg.: $R_{ck} \geq 45 \text{ N/mm}^2$ (C45/55)	Classe di consistenza: S4
Base (cm)	VAR.					Classe di resistenza cls. allo scasso: $R_{ck} \geq 20 \text{ N/mm}^2$ (C16/20)	
Altezza (cm)	VAR.					Classe di esposizione EN 206-1: XF1	Rapporto A/C: $\leq 0,45$
Spessore (cm)	VAR.					ACCIAIO: B450C	Aggregato ϕ max: 16 mm
						REI: Copriferro: distanziatore altezza mm 30	Tolleranze di produzione (UNI EN 13369:2008). Definizione di tolleranza: è definita come la differenza tra le due dimensioni limite, minima e massima ($\pm \Delta L$), in riferimento a quella assegnata al manufatto: Lunghezza/larghezza fino a mm 1000 $\pm \Delta L = 10 \text{ mm}$ Lunghezza/larghezza oltre mm 1000 $\pm \Delta L = 9 + L/1000 \text{ (mm)}$ Spessori T ¹ e misure corte (fino a mm 1.000) $\pm \Delta h = 10 \text{ mm}$ Rettilineità "j" in qualsiasi piano principale: $\pm \mu = L/700 \text{ (mm)}$ Squadratura "V" e misure angolari: $\pm \nu = h/1000 \text{ (mm)}$
						-	

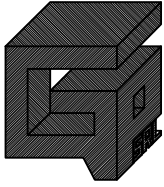

GENERAL PREFABBRICATI S.r.l.

Settore: PREFABBRICAZIONE

Componente: TUBI dim 2000 AUTOPORTANTI IN C.A.V.

Materiali da imp.:

Cls. RcK 450 kg/cmq

Acciaio B450C

peso 66.35 q.li

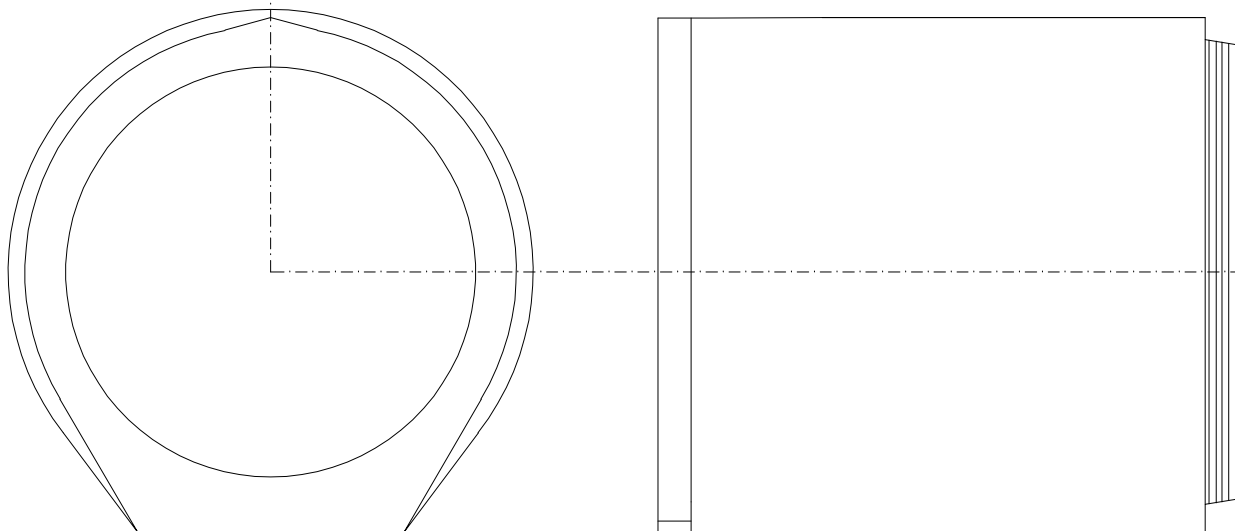
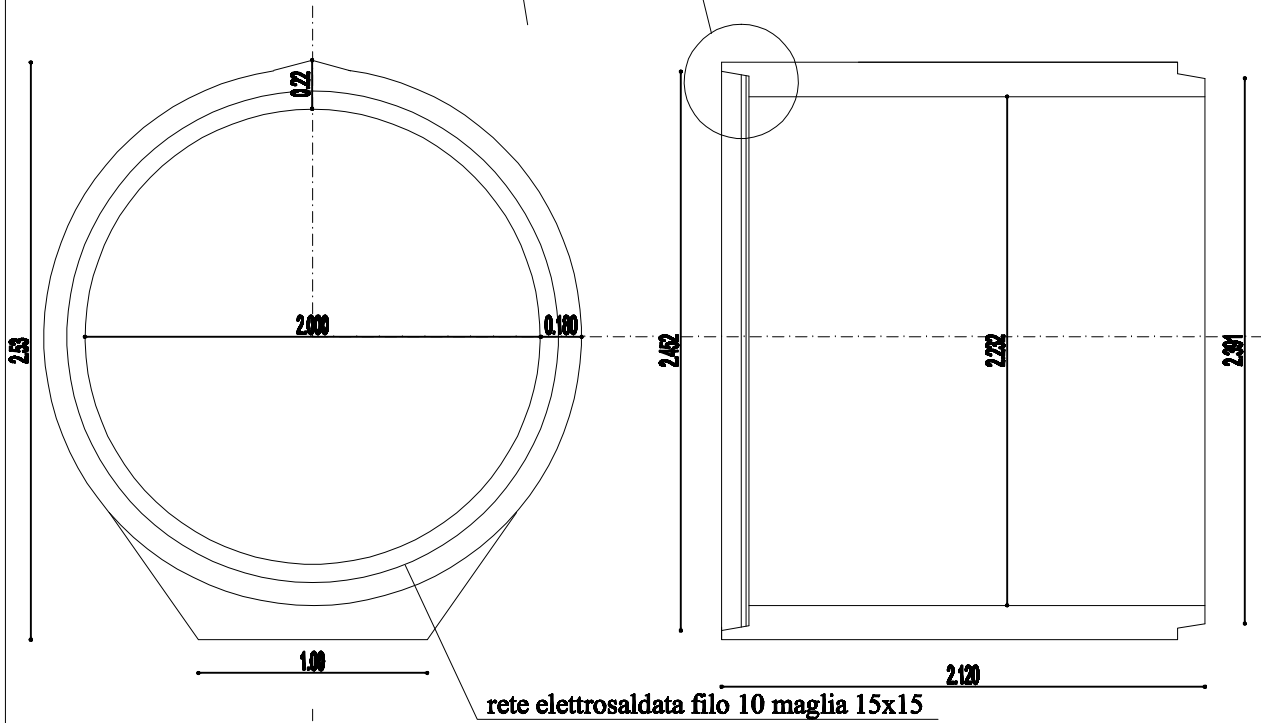
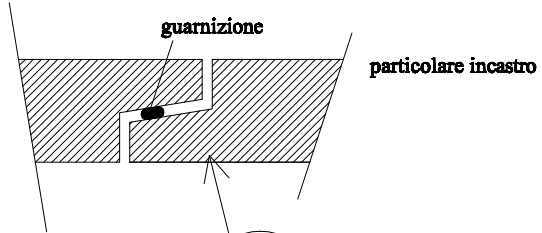

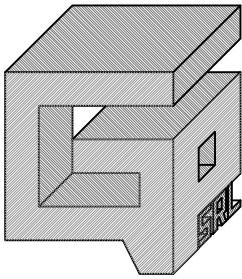

GENERAL PREFABBRICATI S.r.l.

Settore: **PREFABBRICAZIONE**

Componente: **VELETTA LISCIA**
2.40x0.50x0.05

MATERIALI:

Acciaio per cls armato B450C
Cls Rck 350 Kg/cm²
peso circa 1.50 q.li

Prospetto lato staffe

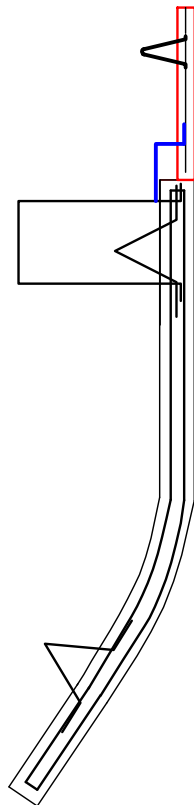
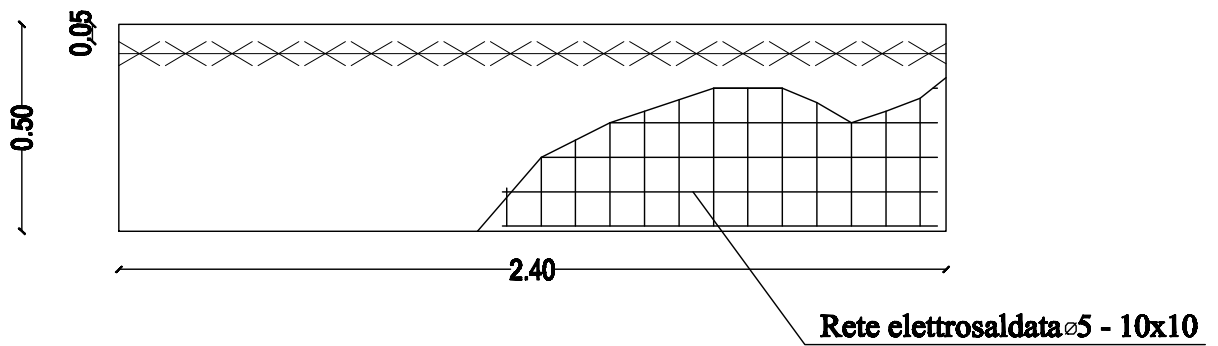

Sezione Tipo

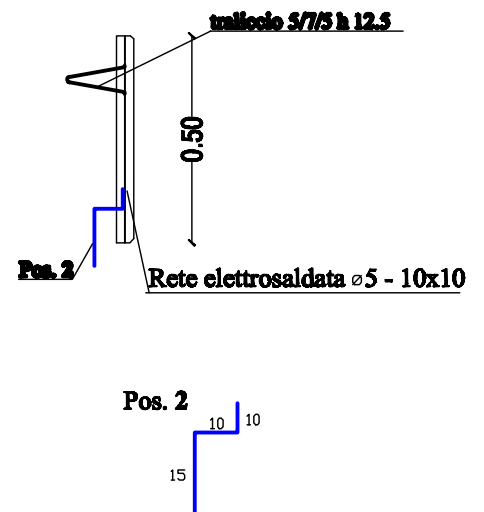

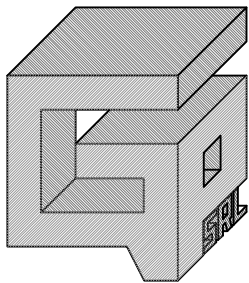

GENERAL PREFABBRICATI S.r.l.

Settore: PREFABBRICAZIONE

**Componente: VELETTA LISCIA
2.40x0.70x0.08**

MATERIALI :

Acciaio per cls armato B450C
Cls Rck 350 Kg/cm²

Prospetto lato staffe

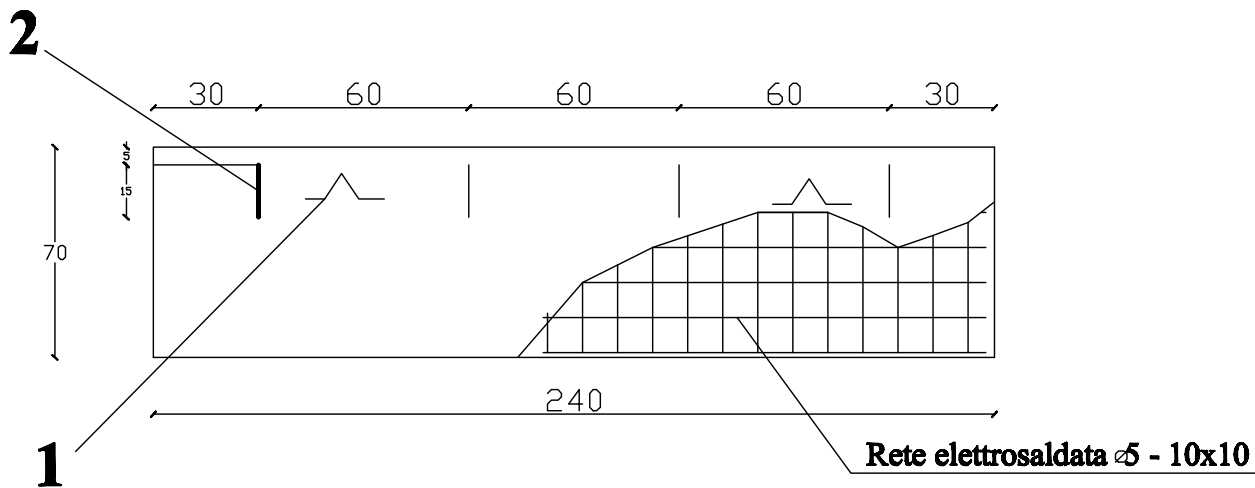

Vista Prospettica

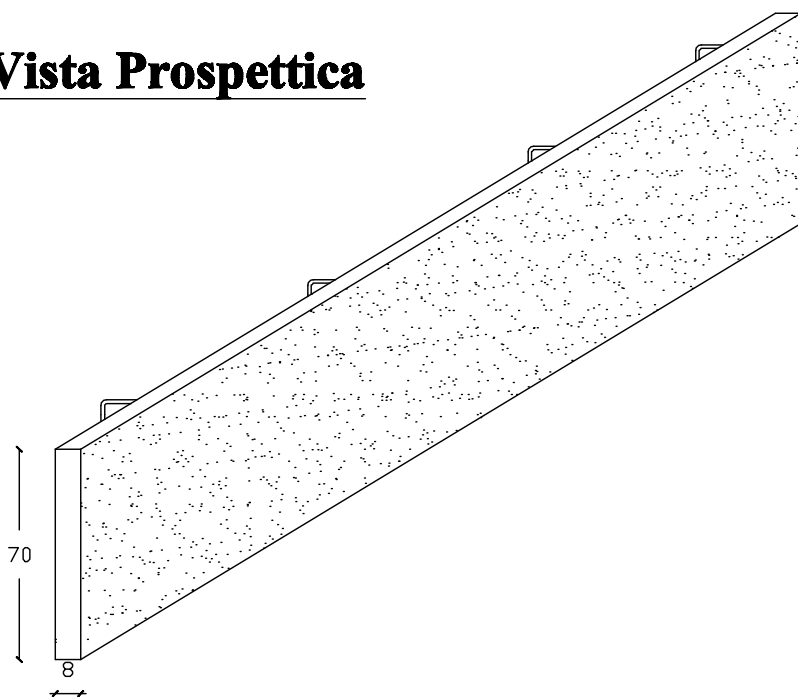

Sezione Tipo

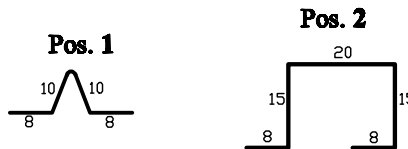
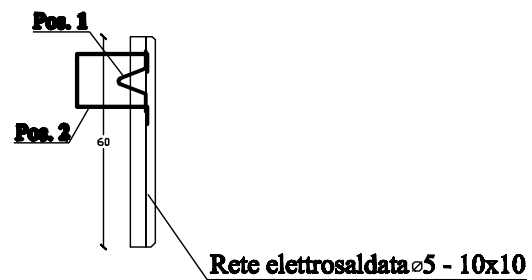

Pos. 1 - N. 2 Ganci di Sollevamento ø10
Pos. 2 - N. 4 Staffe di Angoraggio ø10

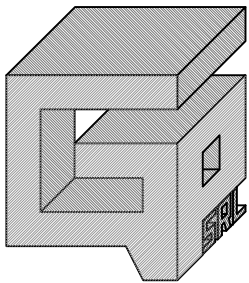

GENERAL PREFABBRICATI S.r.l.

Settore: PREFABBRICAZIONE

**Componente: VELETTA LISCIA
2.40x0.60x0.05**

MATERIALI :

**Acciaio per cls armato B450C
Cls Rck 350 Kg/cm²**

Prospetto lato staffe

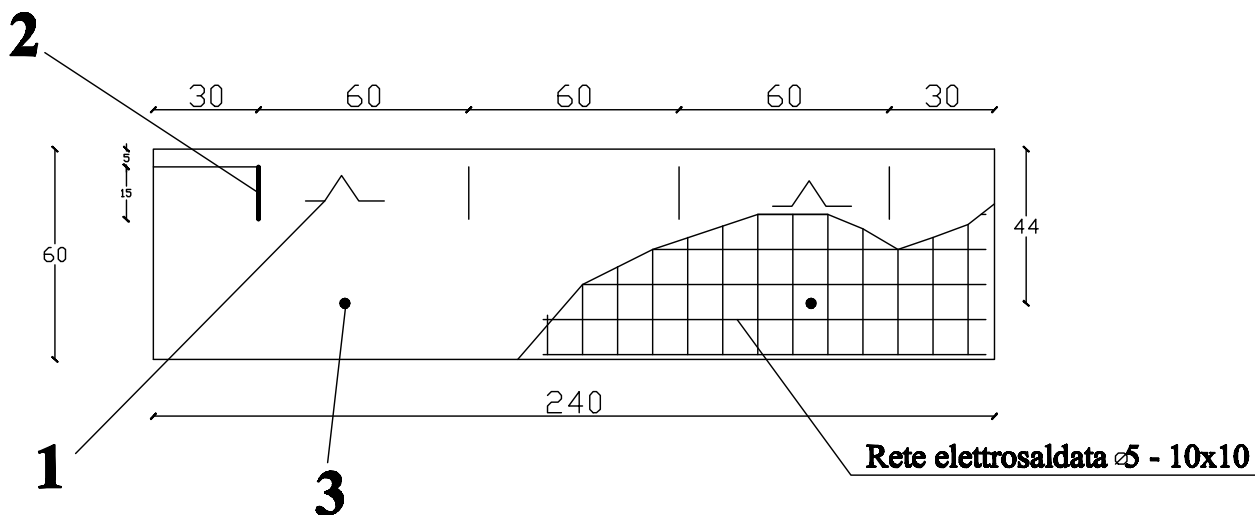

Sezione Tipo

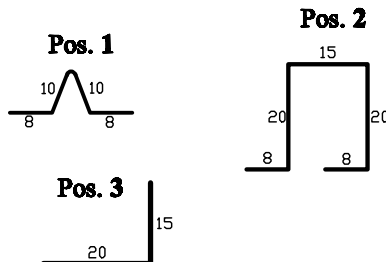
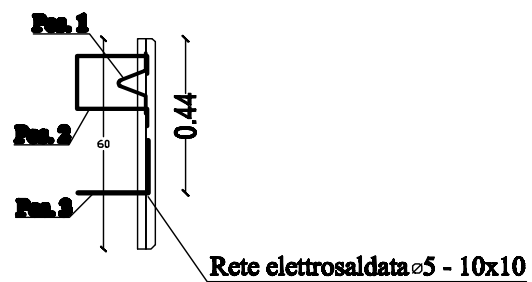

Pos. 1 - N. 2 Ganci di Sollevamento ø10
Pos. 2 - N. 4 Staffe di Angoraggio ø10
Pos. 3 - N. 2 Staffe di Appoggio ø 16

Vista Prospettica

